

THIS COPY IS PROVIDED ON A RESTRICTED BASIS AND IS NOT TO BE USED IN ANY WAY DETRIMENTAL TO THE INTERESTS OF PANDUIT CORP.

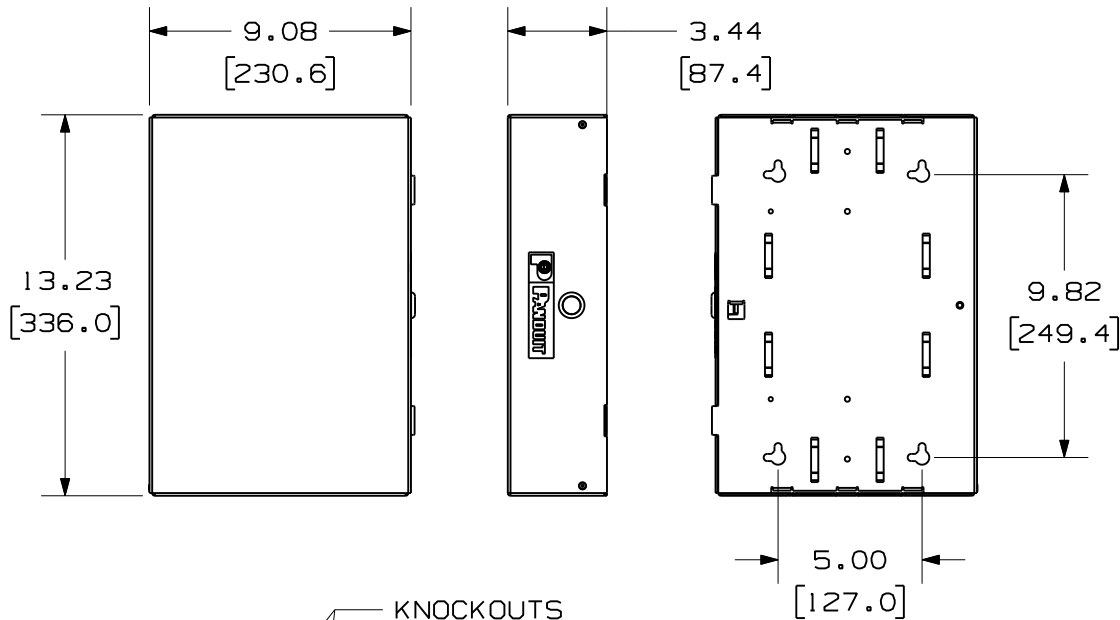

PANDUIT P/N	WEIGHT
WMCPE	2.40 Lbs/EACH PC 1.09 Kgs/EACH PC

NOTES:

1. SEE CURRENT CATALOG FOR ADDITIONAL PART NUMBER SUFFIXES TO INDICATE COLOR AND OR PACKAGE QUANTITY.
2. SEE CATALOG FOR COMPLETE LIST OF PARTS APPLICABLE FOR USE WITH THIS PART.
3. DIMENSIONS IN PARENTHESES ARE IN METRIC.
4. PART INCLUDES:
  - 1- METAL BODY WITH COVER
  - 4- GROMMET EDGING
  - 4- TAK-TY™
  - 2- PUNCHDOWN MOUNTING SCREWS

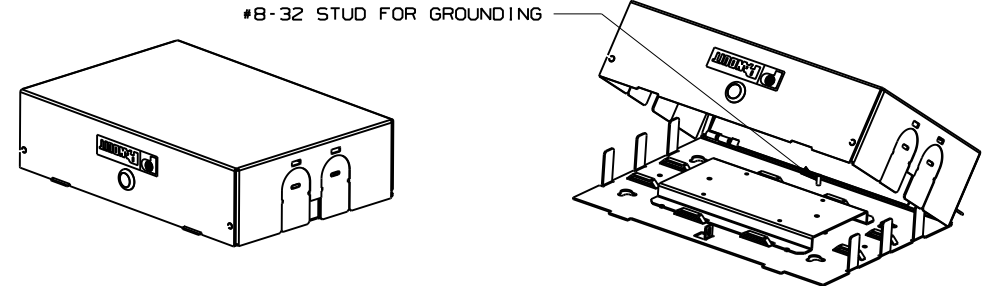
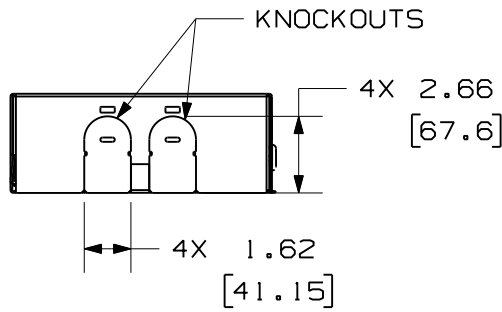

V10694AB/01  
CAD FILENAME/LAYERS  
V10694AB\_DC/01B

**PANDUIT** CORP. TINLEY PARK, ILLINOIS  
PUNCHDOWN CONSOLIDATION POINT ENCLOSURE (WMCPE) CUSTOMER DRAWING

UNLESS OTHERWISE SPECIFIED, DIMENSIONAL TOLERANCES ARE:  
(.X) ± (.XXX) ±  
(.XX) ± ANGLES ±

REV	DATE	BY	CHK	DESCRIPTION	ECN	CHK	CUST	SUP
O1B	4-7-10	BAME	DPN	B. ADDED KNOCKOUT DIMS	V10694AB-DC			
O1A	2-4-10	DSI	DPN	A. ADDED SILKSCREEN LOGO	V10694AB-DC	CMK		
O0A	1-26-10	BAME	DSI	RELEASED TO PRODUCTION.	V10694AB-DC	CMK		

DRAWN BY BAME	MAT'L: ALUMINUM	SCALE NONE
DATE 1-26-10		DRAWING NO. V10694AB-DC
CHECKED BY DSI		DWG A SIZE