

PanZone® Work Area Raised Floor Consolidation Point Enclosure

specifications

The enclosure shall mount into a raised floor office tile, can be concealed with office flooring and be UL 2043 rated for plenum use. The enclosure shall accept Mini-Com® Copper or Fiber Modules. The enclosure shall have the capacity to support 48 copper cables or up to 96 fiber cables. The enclosure shall have flexible air sealing cable ingress/egress grommets that allow for quick and easy moves, adds, and changes, while still maintaining a plenum rating. The enclosure shall be capable of being secured and protected from unauthorized access with a lockable cover.



technical information

Dimensions:	12.37"H x 12.45"W x 7.88"D (314mm x 316mm x 200mm)
Minimum depth of raised floor:	8.88" (226mm) from floor to top of raised floor tile
Cable capacity:	Supports 48 copper cables or up to 96 fiber cables
Installation:	Mounts in 10.5" x 10.5" cutout in one raised floor tile
Packaging:	Raised floor enclosures include built-in 48 Port Mini-Com® Modular Panel, two Cool Boot™ Raised Floor Air Sealing Grommets, lockable cover and mounting hardware
Materials:	Steel
Ratings:	UL2043 rated for use in plenum spaces
Durability:	Tested to 2000 lbs per square inch to support furniture

key features and benefits

In-floor design	Allows access to the patch field within the local work area without removing floor tiles
Aesthetic design for in office use	Mounts in a raised floor environment and can be concealed with office flooring
Integrates Cool Boot™ raised floor air sealing grommet	Manages airflow when making moves, adds, and changes to conserve energy
Lockable cover	Protects against unauthorized access for increased security and network reliability
Modularity	Accepts Mini-Com® Copper or Fiber Modules that snap in and out to simplify moves, adds, and changes

applications

The PanZone® Work Area Consolidation Point Enclosures is an ideal raised floor office solution as a consolidation point for workstations, phones, printers and connected building devices without requiring access to the telecommunications room. The raised floor enclosure saves valuable real estate by providing space below the raised floor for up to 48 copper cables or up to 96 fiber cables. This enclosure allows for quick and easy

moves, adds and changes for today's dynamic office environments. The raised floor enclosure is capable of accommodating field terminated or pre-terminated modular copper or fiber assemblies for rapid deployments and reconfigurations. The enclosure also provides an efficient and cost effective method to design and deploy structured cabling systems for open office architecture in any raised floor application.

www.panduit.com

PanZone® Work Area Raised Floor Consolidation Point Enclosure

48 port: ACE48

Mini-Com® Copper UTP Jack Modules

Category 6A: CJ6X88TGBU
Category 6: CJ688TGBU
Category 5e: CJ5E88TGBU

Mini-Com® Copper Shielded Jack Modules

Category 6A: CJS6X88TGY
Category 6: CJS688TGY
Category 5e: CJS5E88TGY

Mini-Com® Fiber Optic Adapter Modules

Accepts any Mini-Com® Compatible Fiber Optic Adapter Modules

Mini-Com® BAS Connector Module

2 module space connector: CMBRS485

QuickNet® Pre-Terminated Copper and Fiber Cable Assemblies

Accepts any QuickNet™ Copper or Fiber Cabling Assembly to Mini-Com® Modular Jacks

PanZone® Plug to Plug Zone Cords

Category 6A UTP

Plenum: UAPPBU25
Riser: UAPRBU25

Category 6 UTP

Plenum: UPPBU25Y
Riser: UPBU25Y

PanZone® Plug to Jack Module Zone Cords

Category 6A UTP

Plenum: UAJPBU25BL
Riser: UAJRBU25BL

Category 6 UTP

Plenum: UJPBU15BLY
Riser: UJBU15BLY



PanZone® Work Area Raised Floor Consolidation Point Enclosure

Sold by:

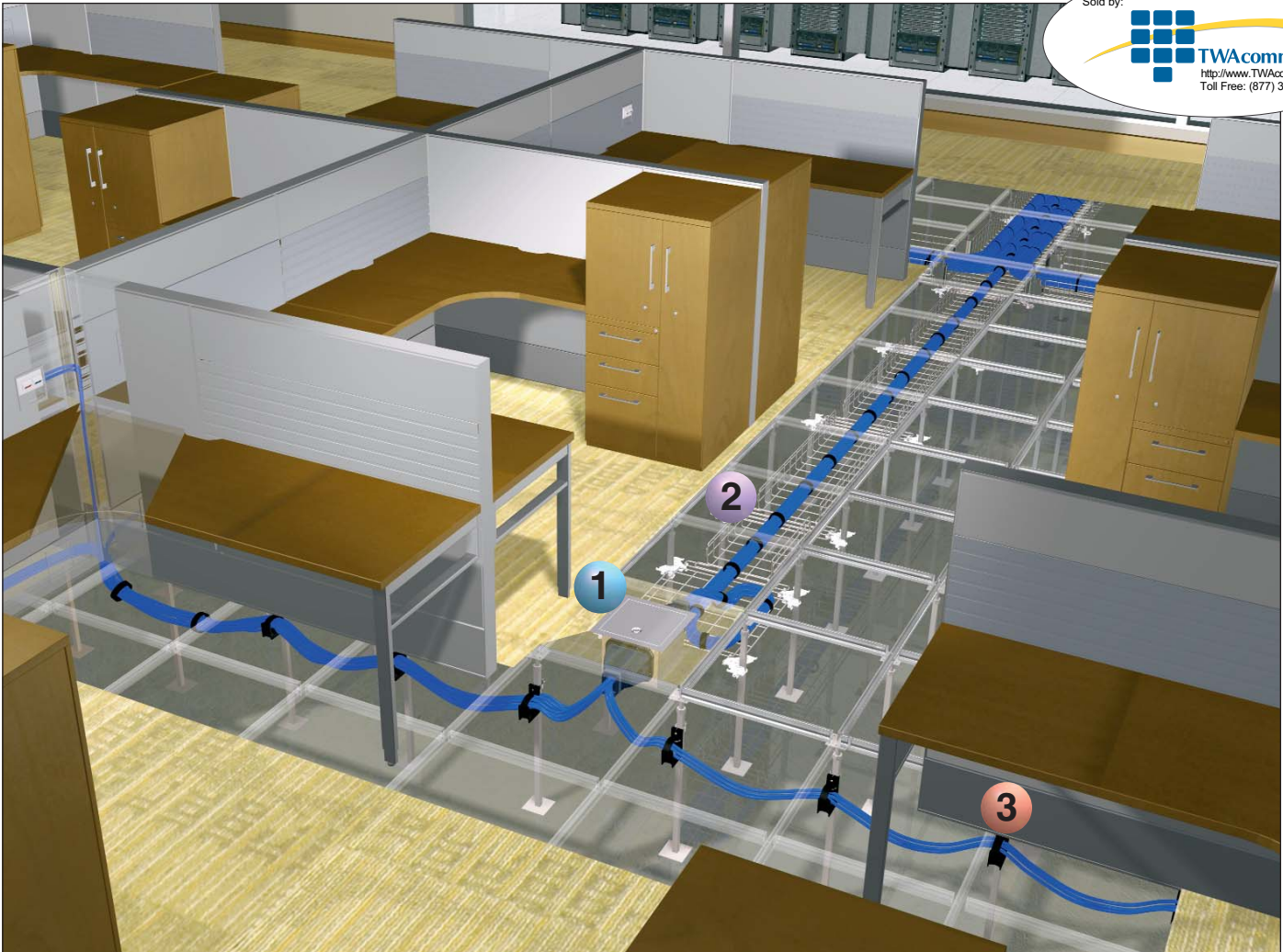

1 PanZone® Work Area Raised Floor Consolidation Point Enclosure – ACE48



2 GridRunner™ Underfloor Cable Routing System*

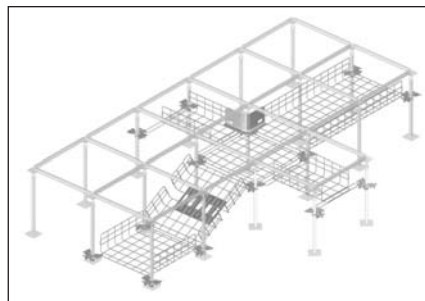

3 J-PRO™ Cable Support System* – JP2UF100-L20



*For the GridRunner Underfloor Cable Routing System and J-Pro Cable Support System refer to Physical Infrastructure Solutions Catalog, SA-NCCB51 or www.panduit.com for more information.

WORLDWIDE SUBSIDIARIES AND SALES OFFICES

PANDUIT CANADA
Markham, Ontario
cs-cdn@panduit.com
Phone: 800.777.3300

PANDUIT EUROPE LTD.
London, UK
cs-emea@panduit.com
Phone: 44.20.8601.7200

PANDUIT SINGAPORE PTE. LTD.
Republic of Singapore
cs-ap@panduit.com
Phone: 65.6305.7575

PANDUIT JAPAN
Tokyo, Japan
cs-japan@panduit.com
Phone: 81.3.6863.6000

PANDUIT LATIN AMERICA
Jalisco, Mexico
cs-la@panduit.com
Phone: 52.33.3777.6000

PANDUIT AUSTRALIA PTY. LTD.
Victoria, Australia
cs-aus@panduit.com
Phone: 61.3.9794.9020

For a copy of Panduit product warranties, log on to www.panduit.com/warranty

For more information

Visit us at www.panduit.com

Contact Customer Service by email: cs@panduit.com
or by phone: 800-777-3300 and reference ZCSP09

PANDUIT®

©2010 Panduit Corp.
ALL RIGHTS RESERVED.

WW-ZCSP09

6/2010