

The Problem-Solver: Leviton's New Power Base Adaptor



Problem:

Hard ceilings with limited access for low-voltage wiring installations of occupancy sensors

Solution:

Leviton's New Power Base Adaptor

Problem solved.

Convert any Leviton low-voltage ceiling sensor to line voltage.
(Occupancy sensor not included.)

Description

Leviton's OPB15-0DW is a self-contained transformer and relay adaptor with a patent-pending technology that converts any Leviton low-voltage ceiling sensor to line voltage. The OPB15-0DW conveniently mounts to a standard 2.125" deep x 4" octagon or 2.125" deep x 4" square electrical box. It provides wire leads for simple connection to a line-voltage circuit and a two-part terminal block for fast, easy low-voltage connections to the sensor. The Power Base Adaptor is ideal for both existing buildings with limited access to wiring and new constructions with line-voltage circuiting only.

The OPB15-0DW offers the same performance features as Leviton's OSP Power Pack Series. By providing the flexibility to install Leviton's full line of low-voltage ceiling sensors in any application, the Power Base Adaptor is a "problem solver" that doubles the versatility of Leviton's low-voltage ceiling occupancy sensor offering.

Applications

- Lavatories
- Remodels in hard ceiling spaces
- Energy conservation retrofits
- Any installation with limited access for low-voltage wiring installation

Features & Benefits

- Patent-pending ability to convert Leviton low-voltage ceiling sensors to line-voltage offers greater versatility in any application
- Streamlined installation offers customers an immediate energy-management solution
- Mounts easily in electrical box and provides leads for simple line voltage connection
- Two-piece terminal block provides fast, easy low-voltage connections to the sensor
- Zero-crossing circuitry for enhanced reliability and long-life operation

Agency Standards and Compliance

OPB15-0DW
• UL and cUL Listed
• NOM
• CEC Title-24
• Backed by Limited Five-Year Warranty



Ordering Information

Description	Cat. No.	Color
Occupancy Sensor Power Base Adaptor	OPB15-0DW	White

Installation

The OPB15-0DW Power Base Adaptor mounts in a standard 2.125" deep x 4" octagon or 2.125" deep x 4" square electrical box with a 2-gang mud ring. The flying leads permit quick electrical connection to the line-voltage circuit. A two-part terminal block is provided for fast, easy low-voltage connections to the sensor. Works with Leviton's complete OSC family of low-voltage sensors.

Sensor Wiring

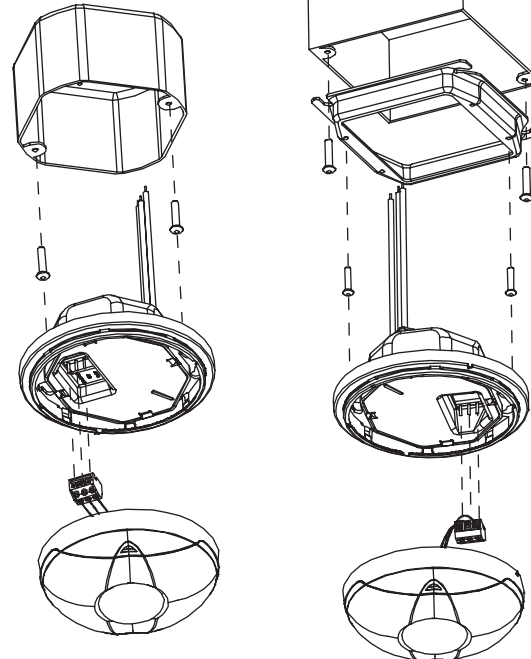

Specifications

Electrical
Input Voltage: 120/277 VAC @ 60Hz
Output Voltage: 24 VDC, 40mA nominal, full-wave rectified and filtered, unregulated. (Each Leviton sensor contains an internal voltage regulator.)
Load Rating: 15A Incandescent, Electronic or Magnetic Fluorescent Ballast; 3/4 HP at 120V
Wire Designation: Line-Black, Load-Blue, White-Neutral
Environmental
Operating Temperature Range: 0°C to 40°C
Storage Temperature Range: -10°C to 85°C
Relative Humidity: 0% to 90% non-condensing
Physical
Case: High impact plastic
Relay: Class B (130°C). Silver alloy contacts switching relay-120/277 VAC
Wire: 6" leads 14 AWG for line voltage. Two-part terminal block for low voltage connections.
Size: 4.5" dia. x 1.75" deep
Color: White



For Technical Assistance call: 1-503-404-5500
Leviton Manufacturing Co., Inc.
 P.O. Box 2210, Tualatin, OR 97062
 Telephone: 1-503-404-5500 • FAX: 1-503-404-5600
 Tech Line (8:00AM–5:00PM Pacific Time Monday–Friday): 1-503-404-5500
Visit Leviton's Web site at www.lms.leviton.com