

17 Series — Taper Nose — Up to 690 AMP,* 600V

*Refer to Ampacity Chart for all cable sizes on page JJ2



17D21-W



17D23-E

Male Detachable Plug—Double Set Screw (Cable Size: 250–350MCM)

COLOR	COMPLETE CAT. NO.	CONTACT CAT. NO.	INSULATOR CAT. NO.
Black	17D21-E	17D21-C	17SDM-E
White	17D21-W	17D21-C	17SDM-W
Red	17D21-R	17D21-C	17SDM-R
Blue	17D21-B	17D21-C	17SDM-B
Green	17D21-G	17D21-C	17SDM-G
Yellow	17D21-Y	17D21-C	17SDM-Y
Orange	17D21-O	17D21-C	17SDM-O
Brown	17D21-H	17D21-C	17SDM-H

Female Detachable Plug—Double Set Screw (Cable Size: 250–350MCM)

COLOR	COMPLETE CAT. NO.	CONTACT CAT. NO.	INSULATOR CAT. NO.
Black	17D23-E	17D23-C	17SDF-E
White	17D23-W	17D23-C	17SDF-W
Red	17D23-R	17D23-C	17SDF-R
Blue	17D23-B	17D23-C	17SDF-B
Green	17D23-G	17D23-C	17SDF-G
Yellow	17D23-Y	17D23-C	17SDF-Y
Orange	17D23-O	17D23-C	17SDF-O
Brown	17D23-H	17D23-C	17SDF-H

SPECIFICATIONS & FEATURES

- The 17 Series Taper Nose connectors withstand grueling, heavy-duty industrial use. Applications include generator test stations, water purification plants, electro-chemical machining equipment and other general industrial uses.

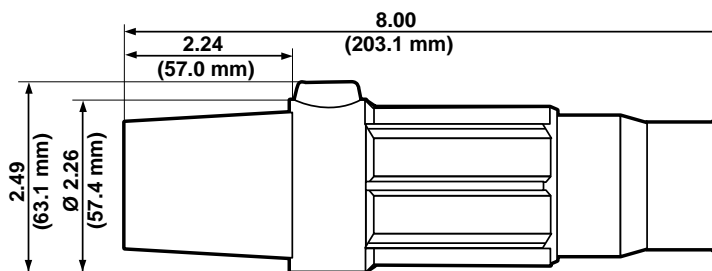

MALE DETACHABLE PLUG—DOUBLE SET SCREW
Cat. No. 17D21

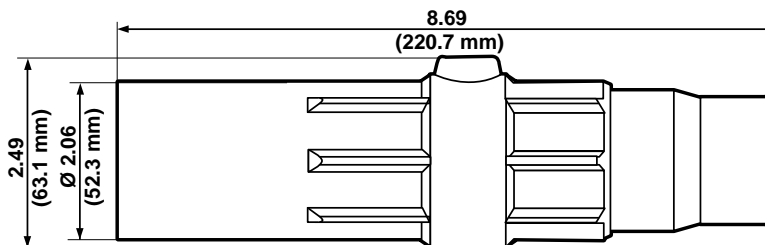

FEMALE DETACHABLE PLUG—DOUBLE SET SCREW
Cat. No. 17D23

