

## Connector Interface Bezels

### APPLICATION

Leviton's snap-on Multimedia, 8P8C and MT-RJ Connector Interface Bezels adapt a variety of connectors to Australian-style Clipsal and HPM wallplates. Multimedia Connector Interface Bezels can be used with QuickPort® BNC, RCA, S-Video, Banana Jack, F-Connectors, Binding Posts, and LC, FC, ST® and SC fiber adapters. 8P8C Connector Interface Bezels are suitable for any Category 5, 5e and 6 connectors. Spectro-Link™ Frame-Station adapters work with MT-RJ Connector Interface Bezels.

### STANDARDS COMPLIANCE

Meets all applicable standards: ACA.

### PHYSICAL SPECIFICATIONS

Materials: Fire-retardant plastic rated ULV-940.  
Dimensions: .933"H x .883"W x .569"D

### DESIGN CONSIDERATIONS

- Multimedia Connector Interface Bezels are compatible with SC, LC, ST, FC fiber adapters, RCA, S-Video, Banana Jacks, Binding Posts, BNC and F-Connectors.
- 8P8C Connector Interface Bezels are compatible with Category 5, 5e or 6 connectors.
- MT-RJ Connector Interface Bezels are compatible with MT-RJ adapters.
- Adapts connectors to Australian-style Clipsal and HPM wallplates.

### WARRANTY INFORMATION

- One-year limited warranty.
- Product and performance warranties are extended to a Lifetime as part of Leviton's Certified Cabling System.

See ELECTRONIC FILES for CAD files (.DXF, .DWG, MS-DOS.EPS) on disk



For ELECTRONIC Typical Specs see (.TXT) file on disk.

### TYPICAL SPECIFICATION

Snap-on Multimedia, 8P8C and MT-RJ Connector Interface Bezels shall adapt a variety of connectors to Australian-style Clipsal and HMP wallplates. They shall meet ACA standards. The bezels shall be made of fire-retardant plastic rated ULV-940. The manufacturer shall provide a one-year limited product warranty. The manufacturer shall provide a lifetime warranty against defects in material and workmanship, and an application guarantee when installed as part of a certified system.



For Technical Support Call 1-425-485-4288; in USA call 1-800-824-3005  
Spec sheets and updates are also available at [www.levitonvoicedata.com](http://www.levitonvoicedata.com).

# Connector Interface Bezels

Part Numbers  
 5G109-A\*5 61100-A\*6  
 BEZEL-WHT BEZEL-MTW  
 BEZEL-MTE BEZEL-MBW  
 .....

## DIMENSIONAL LINE ART

See ELECTRONIC FILES for CAD images  
 (.DXF, .DWG, MS-DOS.EPS)

PN# BEZEL-WHT

PN# 5G109-A\*5 (jack not shown)

PN# 61100-A\*6 (jack not shown)

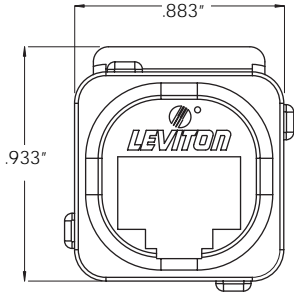

Front View

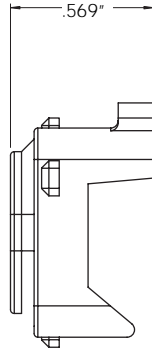

Side View

PN# BEZEL-MBW

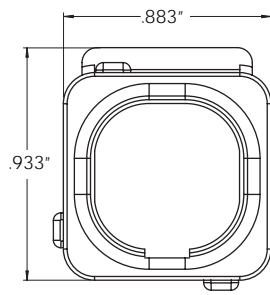

Front View

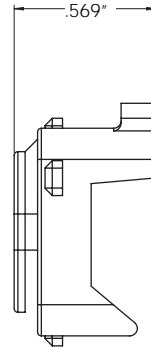

Side View

PN# BEZEL-MTE, BEZEL-MTW

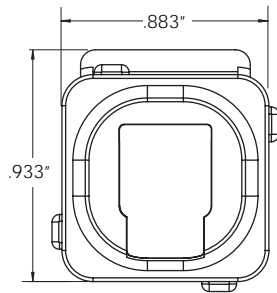

Front View

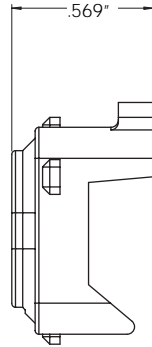

Side View

## PART NUMBERS

Connector Interface Bezels	Part No.
8P8C Connector Interface Bezel and GigaMax™ 5e connector (w/Leviton logo)	5G109-A*5
8P8C Connector Interface Bezel and eXtreme 6™ connector (w/Leviton logo)	61100-A*6
8P8C Connector Interface Bezel, white	BEZEL-WHT
MT-RJ Connector Interface Bezel, white	BEZEL-MTW
MT-RJ Connector Interface Bezel, black	BEZEL-MTE
Multimedia Connector Interface Bezel, white	BEZEL-MBW

\*= Color choices: Ivory(I), White(W), Grey(G), Black(E), Orange(O), Blue(L), Crimson Red(C), Yellow(Y), Green(V), Purple(P), Almond(A), Brown(B), Dark Red(R)



For Technical Support Call 1-425-485-4288; in USA call 1-800-824-3005  
 Spec sheets and updates are also available at [www.levitonvoicedata.com](http://www.levitonvoicedata.com).



2222 – 222nd St. SE • Bothell, WA 98021 USA • Tel: 1-800-722-2082 / 1-425-485-4288 • Fax: 1-425-483-5270 • Int'l Fax: 1-425-485-9170