

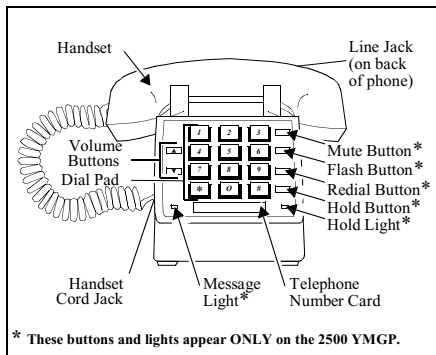

**2500 MMGN, 2500 YMGP, 2554 MMGN,  
2554 YMGP Telephones Quick Reference Guide**

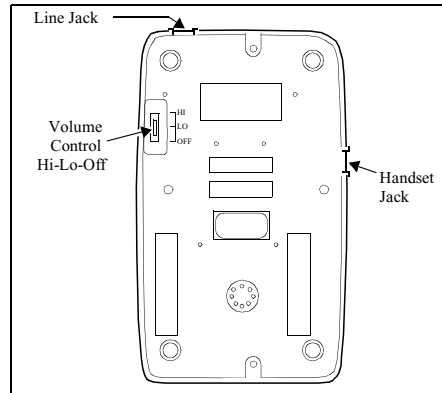

The 2500 MMGN and 2500 YMGP Telephone, Top View



The 2500 MMGN and 2500 YMGP, Bottom View

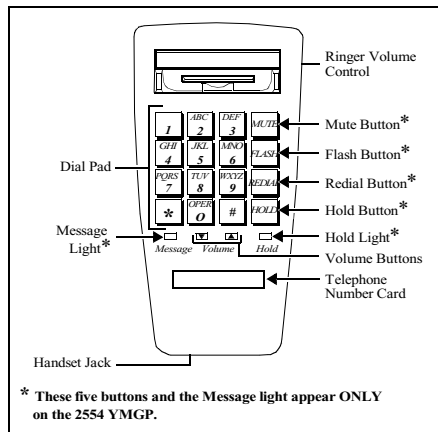

The 2554 MMGN and 2554 YMGP Telephones, Top View

**Special Features on the 2500 MMGN and 2500 YMGP, and the 2554 MMGN and 2554 YMGP Telephones:**

The **Mute Button** (only on the 2500/2554 YMGP models) — press (and hold down) **[Mute]** to turn off the handset microphone. In this way, the other person on the call cannot hear your conversation.

The **FLASH Button** (only on the 2500/2554 YMGP models) — press **[Flash]** instead of pressing the switchhook for features such as Conference with business communications systems, and for custom calling features if you are using your telephone at home.

The **Redial Button** (only on the 2500/2554 YMGP models) — press **[Redial]** to automatically redial the last number you dialed. The telephone retains in memory the last number dialed (up to 28 digits) for a period of 24 hours, provided line power is maintained to the telephone.

The **Hold Button** (only on the 2500/2554 YMGP models) — press **[Hold]** to put a call on hold until you can return to it. In order to return to the held call, press **[Hold]** again, or if you have hung up, pick up the handset. If you desire music-on-hold or a second dial tone, contact your system manager.

The **Message Light** (only on the 2500/2554 YMGP models) — a red light which flashes when a message has been left for you. You may need to contact your attendant to retrieve your messages.

The **Telephone Number Card** (on all telephone models) — for writing your area code and telephone number or your extension.

The **Ringer Volume Control** (on all telephone models) — for raising or lowering the volume of the tone ringer on your telephone. There are three settings: High, Low, and Off.

**IMPORTANT SAFETY INSTRUCTIONS**

The most careful attention has been devoted to quality standards in the manufacture of your new telephone. Safety is a major factor in the design of every set, but, safety is YOUR responsibility too.

Please read carefully the helpful tips listed below and on the next page. These suggestions will enable you to take full advantage of your new telephone. Then, retain these tips for later use.

**Use**

When using your telephone equipment, the following safety precautions should always be followed to reduce the risk of fire, electric shock, and injury to persons.

- Read and understand all instructions.
- Follow all warnings and instructions marked on the telephone.
- This telephone can be hazardous if immersed in water. To avoid the possibility of electric shock, do not use it while you are wet. If you accidentally drop the telephone into water, do not retrieve it until you have first unplugged the line cord from the modular jack. Then, call service personnel to ask about a replacement.
- Avoid using the telephone during electrical storms in your immediate area. There is a risk of electric shock from lightning. Urgent calls should be brief. Even though protective measures may have been installed to limit electrical surges from entering your business, absolute protection from lightning is impossible.
- If you suspect a natural gas leak, report it immediately, but use a telephone away from the area in question. The telephone's electrical contacts could generate a tiny spark. While unlikely, it is possible that this spark could ignite heavy concentrations of gas.
- Never push objects of any kind into the equipment through housing slots since they may touch hazardous voltage points or short out parts that could result in a risk of electric shock. Never spill liquid of any kind on the telephone. If liquid is spilled, however, refer servicing to proper service personnel.
- To reduce the risk of electric shock, do not disassemble this telephone. There are no user serviceable parts. Opening or removing covers may expose you to hazardous voltages. Incorrect reassembly can cause electric shock when the telephone is subsequently used.

**Service**

- 1 Before cleaning, unplug the telephone from the modular wall jack. Do not use liquid cleaners or aerosol cleaners. Use a damp cloth for cleaning.
- 2 Unplug the telephone from the modular wall jack. Be sure to refer servicing to qualified service personnel when these conditions exist:
  - If liquid has been spilled into the telephone.
  - If the telephone has been exposed to rain or water.
  - If the telephone has been dropped or the housing has been damaged.
  - If you note a distinct change in the performance of the telephone.

**SAVE THESE INSTRUCTIONS**



When you see this warning symbol on the product, refer to the instructions booklet packed with the product for more information before proceeding.

## INSTALLING YOUR TELEPHONE

When you receive your telephone, it is fully assembled except for the coiled handset cord. On the 2554 models, the 3-inch line cord is connected to the back of the telephone, but must be plugged into the wall jack. On the 2500 models, the line cord must be connected to the telephone *and* the wall jack.

**Note:** This equipment is registered to be used on telephone lines with "A" type ringing frequencies. However, some telephone companies use a variety of other ringing frequencies (for example, "B", "C"). As a result, this telephone may or may not ring properly when connected to a telephone line that provides other than "A" type ringing. Consult your Lucent Technologies representative for advice.

### Table/Desk Installation for the 2500 Models

Use the 7-foot straight line cord that came with your telephone to connect the telephone to a modular jack.

**WARNING:** Do not plug the handset cord into the line jack on the bottom of your telephone since it could damage your handset and the telephone.

- 1 Plug one end of the line cord into the line jack on the base of the telephone. You should hear the modular jack click into place.
- 2 Plug one end of the coiled handset cord into the handset jack on the base of the telephone until you hear the modular jack click into place.
- 3 Plug the other end of the handset cord into the handset.
- 4 Put the handset aside and turn the telephone over. Set the Ring Volume Control switch to the setting you want (Off/Lo/Hi).
- 5 Turn the telephone right-side up and place it on your desk or table.
- 6 Hang up the handset.
- 7 Plug the free end of the line cord into a telephone jack in your office.
- 8 Fill out the number card and place it on your telephone.
- 9 Lift the handset and listen for dial tone.

### Wall Installation for the 2554 Models

- 10 Plug the 3-inch line cord into the line jack on the back of the telephone into the modular wall jack. You should hear the modular jack click into place.
- 11 Align the mounting slots on the back of the telephone with the studs on the wall jack. Then, push the telephone firmly against the wall jack, and pull down until it is held securely by the mounting studs. (See the following figure.)

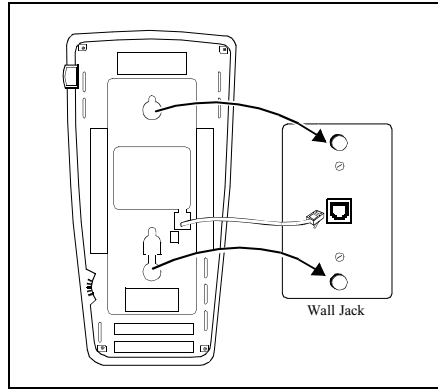

### Wall Mounting the 2554 Model

- 12 Plug one end of the coiled handset cord into the handset. Then, plug the other end into the jack at the base of the telephone. Hang up the handset.
- 13 Fill out the number card and place it on your telephone.
- 14 Lift the handset and listen for dial tone.

## FCC REGULATIONS Pertaining to this equipment

### Interference Information (Part 15)

**WARNING:** Some telephone equipment generates and uses radio frequency energy and if not installed and used properly, that is, in strict accordance with the manufacturer's instructions, may cause interference to radio and television reception. These telephones have been type tested and found to comply with the limits for a Class B computing device in accordance with the specifications in Subpart J of Part 15 of FCC Rules, which are designed to provide reasonable protection against such interference in a residential installation. particular installation.

If this product causes interference to radio or television reception when in use, you might correct the interference with any one of all of these measures:

- However, there is no guarantee that interference will not occur in a particular installation. If this equipment does cause interference to radio or television reception, which can be determined by turning the equipment on and off, the user is encouraged to try to correct the interference by one or more of the following measures:
  - Where it can be done safely, reorient the receiving television, radio, or radio antennae where this may be done safely.
  - To the extent possible, relocate the receiver with respect to the telephone equipment.
  - If the telephone equipment requires ac power, plug the telephone into a different ac outlet so that the telephone equipment and receiver are on different branch circuit.

## Registration Information (Part 68)

Your new telephones have been registered with the Federal Communications Commission (FCC). This product complies with standards in Part 68 of the FCC rules. The FCC requires us to provide you with the following information:

Connection of this equipment to the telephone network must be through one of the standard network interface jacks listed. These may be ordered from the local telephone company or through Lucent Technologies as your authorized agent.

Registered equipment may not be used with coin telephone lines or party lines.

Customers connecting equipment to the telephone network will, upon request of the local telephone company, provide the following information:

- Your phone number.
- The telephone equipment's FCC registration number and ringer equivalence number (REN). These numbers are on the back or bottom of your telephone equipment. The REN is useful to determine how many devices you may connect to your telephone line and still have them ring when your telephone line is called. At most, but not all areas, the sum of all REN's should be 5 or less. You may want to contact your local telephone company.

If it is determined that your telephone is malfunctioning, the FCC requires that it not be used and that it be unplugged from the modular outlet until the problem is corrected.

Repairs can only be made by the manufacturer or its authorized agents or by others who may be authorized by the FCC.

If telephone equipment is causing harm to the telephone network, the telephone company may temporarily discontinue your telephone service. If possible, they'll notify you before they interrupt service. If advance notice isn't practical, you'll be notified as soon as possible. You'll be given the opportunity to correct the problem, and you'll be informed of your right to file a complaint with the FCC. Your telephone company may make changes in its facilities, equipment, operations or procedures that could affect the proper functioning of your Lucent Technologies product. If such changes are planned, you'll be notified in writing to allow you an opportunity to maintain uninterrupted telephone service.

This telephone is compatible with inductively coupled hearing aids.

## WARRANTY INFORMATION

All terms and conditions specified in your agreement with Lucent Technologies apply.

## CANADIAN REGULATIONS

This digital apparatus does not exceed the Class B limits for radio noise emissions from digital apparatus set out in the interference-causing equipment standard entitled "Digital Apparatus," ICES-003 of the Department of Communications.

**NOTICE:** The Canadian Department of Communications label identifies certified equipment. This certification means that the equipment meets certain telecommunications network protective, operational and safety requirements. The Department does not guarantee the equipment will operate to the user's satisfaction.

Before installing this equipment, users should ensure that it is permissible to be connected to the facilities of the local telecommunications company. The equipment must also be installed using an acceptable method of connection. The customer should be aware that compliance with the above conditions may not prevent degradation of service in some situations.

Repairs to certified equipment should be coordinated by a representative designated by the supplier. Any repairs or alterations made by the user to this equipment, or equipment malfunctions, may give the telecommunications company cause to request the user to disconnect the equipment.

Users should ensure for their own protection that the electrical ground connections of the power utility, telephone lines and internal metallic water pipe system, if present, are connected together. This precaution may be particularly important in rural areas.

**CAUTION:** Users should not attempt to make such connections themselves, but should contact the appropriate electrical inspection authority, or electrician, as appropriate.

**NOTICE:** The Ringer Equivalence Number (REN) assigned to each terminal device provides an indication of the maximum number of terminals allowed to be connected to a telephone interface. The termination on an interface may consist of any combination of devices subject only to the requirement that the sum of the Ringer Equivalence Numbers of all the devices does not exceed 5.

APPARATUS CODE	RINGER EQUIVALENCE NUMBER (REN)	NETWORK INTERFACES
2500 MMGN	0.4A, 0.8B	CA11A, CA14A; RJ11C, RJ14C
2500 YMGP	0.5A, 0.9B	CA11A, CA14A; RJ11C, RJ14C
2554 MMGN	0.4A, 0.8B	CA11A, CA14W; RJ11C, RJ14C
2554 YMGP	0.5A, 0.9B	CA11A, CA14W; RJ11C, RJ14C

Prepared by  
BCS Product Documentation Development  
Lucent Technologies  
Middletown, NJ 07748-9972

Copyright © 1999  
Lucent Technologies



Copyright © 1998 Lucent Technologies