

Component Specifications

Part Numbers
48213-*DC

Decora® Camera

APPLICATION

The Decora® Camera provides high-quality color video output that will run through the Structured Media™ Center and connect to a receiver anywhere in the home or office instantly turning a home media center into a home security center. With the Video Sequencer, up to four Decora Cameras or Indoor/Outdoor Cameras, in any combination, may be monitored sequentially.

PHYSICAL SPECIFICATIONS

Dimensions:	4.1" h x 1.4" w x 2.2" d
Connection:	4-position, removable screw terminal.
Transmission Total Harmonic Distortion:	-75 dBc.
Power:	12 VDC @ 35mA typical, 50mA max; green Power On LED.
Imager:	CMOS color.
Size:	1/3"
Gamma Correction:	0.45 -on/off.
Lens:	3.5mm.
Signal/Noise Ratio:	38dB min.
Array Size:	510 x 492.
Minimum Illumination:	5 lux.
Resolution:	310 TV lines.
Supply Voltage:	10.5-12 VDC.
Scanning:	2:1 interlace.
Auto Shutter:	1/60-1/15000 second.
Video Output:	NTSC 2V p-p (75 ohm load).
Current Required:	25 mA
Operating Temperature:	-10°C to +55°C
Humidity Limits:	0 to 95% humidity.

DESIGN CONSIDERATIONS

- Attractive Decora design.
- Self-contained video differential amp provides increased clarity of signal.
- CMOS-based wide-angle color video camera in one compact Decora-style unit.
- Features terminal block output connections.
- Power is indicated by a green LED on faceplate.
- Auto white balance, exposure, shutter, and gain control.

See ELECTRONIC FILES for CAD files (.DXF, .DWG, MS-DOS.EPS) on disk



WARRANTY INFORMATION

- Two-year limited product warranty.

For ELECTRONIC Typical Specs see (.TXT) file on disk.

TYPICAL SPECIFICATIONS

The Indoor Camera shall be CMOS-based, wide-angle color video with swivel/pan adjustment, a 3.5mm lens and a signal/noise ratio of 38dB minimum. It shall have 310 TV line resolution, and 2:1 interlace scanning. The camera shall have an auto-shutter speed of 1/60-1/15000 second, auto white balance, exposure, shutter and gain control. It shall operate in conditions with up to 95% humidity and between -10°C and +55°C. It shall have a self-contained video differential amp. The manufacturer shall provide a two-year limited warranty.

Decora® Camera



For Applications Engineering Support – Call 1-425-485-4288; in USA call 1-800-722-2082
Spec sheets and updates are also available at www.levitonvoicedata.com.



DIMENSIONAL LINE ART

See ELECTRONIC FILES for CAD images
(.DXF, .DWG, MS-DOS.EPS)

48213-*DC
Decora Camera

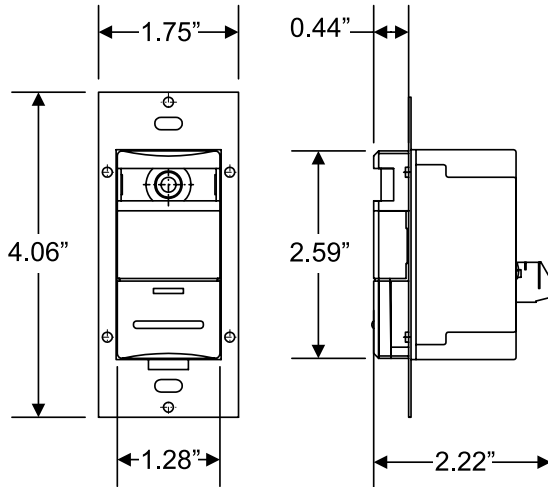

PART NUMBER

Decora Camera	Part Number
Decora Camera	48213-*DC

*=Color choices: (I) Ivory, (W) White, (A) Almond



For Applications Engineering Support – Call 1-425-485-4288; in USA call 1-800-722-2082.
Spec sheets and updates are also available at www.levitonvoicedata.com.



2222 – 222nd St. SE • Bothell, WA 98021 USA • Tel: 1-800-722-2082 / 1-425-485-4288 • Fax: 1-425-483-5270 • Int'l Fax: 1-425-485-9170 • GSA# GS-35F-4785G