

SC Simplex APC, Zirconia Sleeves - Pre-Loaded

| Capacity | Type | Version | Catalog No. |
|----------|--------------------------|--------------|----------------|
| 6 | 6 APC, SC Simplex, Green | Standard | FSPSCA6 |
| 8 | 8 APC, SC Simplex, Green | High-Density | FSPSCA8 |



FSPSCA6



FSPSCA8

FC/PC Simplex, Zirconia Sleeves - Pre-Loaded

| Capacity | Type | Version | Catalog No. |
|----------|-------------------------------|--------------|-----------------|
| 6 | 6 FC/PC Zirconia split sleeve | Standard | FSPFC6 |
| 8 | 8 FC/PC Zirconia split sleeve | High-Density | FSPFCSS8 |



FSPFC6

MTP Adapter Panels - Pre-Loaded

| Capacity | Type | Version | Catalog No. |
|----------|--------------|----------|------------------|
| 72 | 6 MTP, Aqua | Standard | FSPMTPAQ6 |
| 72 | 6 MTP, Beige | Standard | FSPMTPBE6 |
| 72 | 6 MTP, Black | Standard | FSPMTP6 |



FSPMTPAQ6



FSPMTPBE6



FSPMTP6

Unloaded FSP Adapter Panels

| Capacity | Type | Version | Catalog No. |
|----------|--|--------------|------------------|
| 6 | SC Simplex or MT-RJ | Standard | FSPMTRJ6X |
| 8 | SC Simplex or MT-RJ | High-Density | FSPMTRJ8X |
| 3 | SC Duplex or LC Quad | Standard | FSPSCD3X |
| 6 | SC Duplex or LC Quad | High-Density | FSPSCD6X |
| 6 | ST-style | Standard | FSPST6X |
| 8 | SC Duplex or LC Quad | High-Density | FSPST8X |
| 6 | LC Duplex | Standard | FSPLC6X |
| 6 | JACK-PACK® - HXJ jacks/AV connectors | High-Density | FSPHD6X |



FSPMTRJ6X



FSPMTRJ8X



FSPSCD3X



FSPSCD6X



FSPST6X



FSPST8X

Blank FSP Plates



FSPB

| Type | Catalog No. |
|-------|-------------|
| Blank | FSPB |

DIMENSIONS

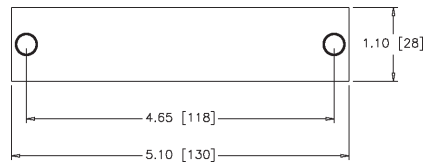

Hubbell Premise Wiring

HUBBELL INCORPORATED (Delaware)

14 Lord's Hill Road • Stonington, CT 06378-0901 • (860) 535-8326 • 800-626-0005

Fax: (860) 535-8328 • Internet site: <http://www.hubbell-premise.com>

Worldwide Locations

Hubbell Premise Wiring, Asia Pacific
Hubbell Canada Inc.
Hubbell Premise Wiring, Central America
Hubbell Premise Wiring, China
Hubbell Premise Wiring, Europe
Hubbell Wiring Systems, India
Hubbell Int'l. Inc., Korea Branch

852-2836-7131
905-839-1138
506-2260-1616
86-21-6374 2660
44-01283 500500
91-99-0010-3341
(82 2) 2607 1363

Fax: 852-2836-7132
Fax: 905-839-9108
Fax: 506-260-1616
Fax: 86-21-6374 2799
Fax: 44-01283 500400
Fax: 91-80-4022-4033
Fax: (82 2) 2603 7386

Hubbell Premise Wiring, Latin America
Hubbell de Mexico, S.A. de C.V.
Hubbell Premise Wiring, Middle East
Hubbell Premise Wiring, Puerto Rico
Hubbell-Taian Co., Ltd., Taiwan
Hubbell Premise Wiring, Venezuela

305-408-4501
(5255) 9151-9999
971-4-393-4192
787-855-1075
886-2-2522-1862
58-212-5156482

Fax: 305-408-8201
Fax: (5255) 9151-9989
Fax: 971-4-393-4194
Fax: 787-855-3265
Fax: 886-2-2522-1872
Fax: 58-212-6627258



HUBBELL OptiChannel FSP Adapter Panels

High-Density Versions.
Loaded, Unloaded or Blank.
Multimode and Singlemode Applications.

FEATURES

- Various colors available to differentiate networks and applications.
- Available in loaded, unloaded or blank versions.
- Nylatch fasteners used for quick snap in installation.
- SC Simplex APC (Angled Polish Connector) adapter panels available.

SPECIFICATIONS

- ◆ Cold Rolled Steel panel with a durable black powder coat finish.
- ◆ Meets the requirements of TIA/EIA-568-B.3.
- ◆ Operating/Storage temp: 0°C to 60°C.
- ◆ Dimensions: 1.1" (28) Wide x 5.1" (130) High.
- ◆ Weight (loaded): 0.1 lbs.
- ◆ FC/PC adapter housings are Nickel-plated machined brass.
- ◆ ST-style adapters have black oxide Nickel-plated Zinc die-cast housings.
- ◆ High-retention phosphor bronze alignment sleeves recommended for most applications.
- ◆ Zirconia precision alignment sleeves recommended for Singlemode applications.



Modular FSP series fiber adapter panels snap into all **OPTICHANNEL™** fiber rack mount panels and wall mount cabinets.

Adapter panels are available as blank plates or with ST-style, SC, FC, MT-RJ, LC, MTP and SC to ST-style adapters. All adapter panels are available in high-density versions.

The **JACK-PACK®** keystone 6-port adapter panel accepts Hubbell Keystone multimedia connections.

FSP Adapter Panels, SC Duplex

Phosphor Bronze Sleeves - Pre-Loaded

| Capacity | Type | Version | Catalog No. |
|----------|---------------------|--------------|-------------------|
| 6 | 3 SC Duplex, Aqua | Standard | FSPSCDM3AQ |
| 12 | 6 SC Duplex, Aqua | High-Density | FSPSCDM6AQ |
| 6 | 3 SC Duplex, Beige | Standard | FSPSCDBE3 |
| 12 | 6 SC Duplex, Beige | High-Density | FSPSCDBE6 |
| 6 | 3 SC Duplex, Black | Standard | FSPSCDM3BK |
| 12 | 6 SC Duplex, Black | High-Density | FSPSCDM6BK |
| 6 | 3 SC Duplex, Blue | Standard | FSPSCD3 |
| 12 | 6 SC Duplex, Blue | High-Density | FSPSCD6 |
| 6 | 3 SC Duplex, Green | Standard | FSPSCDG3 |
| 12 | 6 SC Duplex, Green | High-Density | FSPSCDG6 |
| 6 | 3 SC Duplex, Orange | Standard | FSPSCDO3 |
| 12 | 6 SC Duplex, Orange | High-Density | FSPSCDO6 |
| 6 | 3 SC Duplex, Red | Standard | FSPSCDR3 |
| 12 | 6 SC Duplex, Red | High-Density | FSPSCDR6 |
| 6 | 3 SC Duplex, Yellow | Standard | FSPSCDY3 |
| 12 | 6 SC Duplex, Yellow | High-Density | FSPSCDY6 |

Zirconia Sleeves - Pre-Loaded

| Capacity | Type | Version | Catalog No. |
|----------|---------------------|--------------|-------------------|
| 6 | 3 SC Duplex, Blue | Standard | FSPSCDS3 |
| 12 | 6 SC Duplex, Blue | High-Density | FSPSCDS6 |
| 6 | 3 SC Duplex, Orange | Standard | FSPSCDS3OR |
| 12 | 6 SC Duplex, Orange | High-Density | FSPSCDS6OR |
| 6 | 3 SC Duplex, Red | Standard | FSPSCDS3R |
| 12 | 6 SC Duplex, Red | High-Density | FSPSCDS6R |
| 6 | 3 SC Duplex, Yellow | Standard | FSPSCDS3Y |
| 12 | 6 SC Duplex, Yellow | High-Density | FSPSCDS6Y |



FSPSCDO3



FSPSCDY3



FSPSCD3



FSPSCDG6



FSPSCDY6



FSPSCDR6



FSPSCDBE6

FSP Adapter Panels, LC Duplex



FSPLC6



FSPLCO6

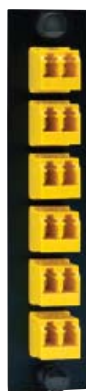

FSPLCY6

Phosphor Bronze Sleeves - Pre-Loaded

| Capacity | Type | Version | Catalog No. |
|----------|---------------------|----------|-------------------|
| 12 | 6 LC Duplex, Aqua | Standard | FSPLCDM6AQ |
| 12 | 6 LC Duplex, Beige | Standard | FSPLCDM6 |
| 12 | 6 LC Duplex, Black | Standard | FSPLCDM6BK |
| 12 | 6 LC Duplex, Blue | Standard | FSPLC6 |
| 12 | 6 LC Duplex, Orange | Standard | FSPLCO6 |
| 12 | 6 LC Duplex, Red | Standard | FSPLCDM6R |
| 12 | 6 LC Duplex, Yellow | Standard | FSPLCY6 |

Zirconia Sleeves - Pre-Loaded

| Capacity | Type | Version | Catalog No. |
|----------|---------------------|----------|-------------------|
| 12 | 6 LC Duplex, blue | Standard | FSPLCDS6 |
| 12 | 6 LC Duplex, aqua | Standard | FSPLCDS6AQ |
| 12 | 6 LC Duplex, black | Standard | FSPLCDS6BK |
| 12 | 6 LC Duplex, orange | Standard | FSPLCDS6OR |
| 12 | 6 LC Duplex, red | Standard | FSPLCDS6R |
| 12 | 6 LC Duplex, yellow | Standard | FSPLCDS6Y |

FSP Adapter Panels, LC Quad



FSPLCQ3



FSPLCQO3



FSPLCQY3

Phosphor Bronze Sleeves - Pre-Loaded

| Capacity | Type | Version | Catalog No. |
|----------|-------------------|--------------|-------------------|
| 12 | 3 LC Quad, Aqua | Standard | FSPLCQM3AQ |
| 24 | 6 LC Quad, Aqua | High-Density | FSPLCQM6AQ |
| 12 | 3 LC Quad, Beige | Standard | FSPLCQM3BE |
| 24 | 6 LC Quad, Beige | High-Density | FSPLCQM6BE |
| 12 | 3 LC Quad, Black | Standard | FSPLCQM3BK |
| 24 | 6 LC Quad, Black | High-Density | FSPLCQM6BK |
| 12 | 3 LC Quad, Blue | Standard | FSPLCQ3 |
| 24 | 6 LC Quad, Blue | High-Density | FSPLCQ6 |
| 12 | 3 LC Quad, Green | Standard | FSPLCQM3GN |
| 24 | 6 LC Quad, Green | High-Density | FSPLCQM6GN |
| 12 | 3 LC Quad, Orange | Standard | FSPLCQO3 |
| 24 | 6 LC Quad, Orange | High-Density | FSPLCQO6 |
| 12 | 3 LC Quad, Red | Standard | FSPLCQM3R |
| 24 | 6 LC Quad, Red | High-Density | FSPLCQM6R |
| 12 | 3 LC Quad, Yellow | Standard | FSPLCQY3 |
| 24 | 6 LC Quad, Yellow | High-Density | FSPLCQY6 |

Zirconia Sleeves - Pre-Loaded

| Capacity | Type | Version | Catalog No. |
|----------|-------------------|--------------|-------------------|
| 12 | 3 LC Quad, Beige | Standard | FSPLCQS3BE |
| 24 | 6 LC Quad, Beige | High-Density | FSPLCQS6BE |
| 12 | 3 LC Quad, Black | Standard | FSPLCQS3BK |
| 24 | 6 LC Quad, Black | High-Density | FSPLCQS6BK |
| 12 | 3 LC Quad, Aqua | Standard | FSPLCQS3AQ |
| 24 | 6 LC Quad, Aqua | High-Density | FSPLCQS6AQ |
| 12 | 3 LC Quad, Blue | Standard | FSPLCQS3 |
| 24 | 6 LC Quad, Blue | High-Density | FSPLCQS6 |
| 12 | 3 LC Quad, Green | Standard | FSPLCQS3GN |
| 24 | 6 LC Quad, Green | High-Density | FSPLCQS6GN |
| 12 | 3 LC Quad, Orange | Standard | FSPLCQS3OR |
| 24 | 6 LC Quad, Orange | High-Density | FSPLCQS6OR |
| 12 | 3 LC Quad, Red | Standard | FSPLCQS3R |
| 24 | 6 LC Quad, Red | High-Density | FSPLCQS6R |
| 12 | 3 LC Quad, Yellow | Standard | FSPLCQS3Y |
| 24 | 6 LC Quad, Yellow | High-Density | FSPLCQS6Y |



FSPLCQM6AQ



FSPLCQO6



FSPLCQY6



FSPLCQM6BE

FSP Adapter Panels, ST-style Simplex

Phosphor Bronze Sleeves - Pre-Loaded

| Capacity | Type | Version | Catalog No. |
|----------|------------|--------------|---------------|
| 6 | 6 ST-style | Standard | FSPST6 |
| 8 | 8 ST-style | High-Density | FSPST8 |

Zirconia Sleeves - Pre-Loaded

| Capacity | Type | Version | Catalog No. |
|----------|------------|----------|-----------------|
| 6 | 6 ST-style | Standard | FSPSTSS6 |



FSPST6



FSPST8

FSP Adapter Panels, ST-style Duplex

Phosphor Bronze Sleeves - Pre-Loaded

| Capacity | Type | Version | Catalog No. |
|----------|-------------------------|--------------|----------------|
| 6 | 3 ST-style Duplex, Blue | Standard | FSPSTD3 |
| 12 | 6 ST-style Duplex, Blue | High-Density | FSPSTD6 |

Zirconia Sleeves - Pre-Loaded

| Capacity | Type | Version | Catalog No. |
|----------|-------------------------|--------------|----------------|
| 6 | 3 ST-style Duplex, Blue | Standard | FSPSTD3 |
| 12 | 6 ST-style Duplex, Blue | High-Density | FSPSTD6 |



FSPSTD3



FSPSTD6

FSP Adapter Panels, SC to ST-style Duplex

Phosphor Bronze Sleeves - Pre-Loaded

| Capacity | Type | Version | Catalog No. |
|----------|------------------------|--------------|-----------------|
| 6 | 3 SC to ST-style, Blue | Standard | FSPSCST3 |
| 12 | 6 SC to ST-style, Blue | High-Density | FSPSCST6 |

Zirconia Sleeves - Pre-Loaded

| Capacity | Type | Version | Catalog No. |
|----------|------------------------|--------------|-------------------|
| 6 | 3 SC to ST-style, Blue | Standard | FSPSCSTDS3 |
| 12 | 6 SC to ST-style, Blue | High-Density | FSPSCSTDS6 |



FSPSCST3

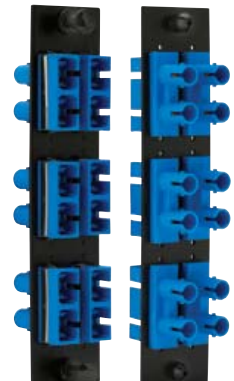

FSPSCST6

FSP Adapter Panels, MT-RJ

Phosphor Bronze Sleeves - Pre-Loaded

| Capacity | Type | Version | Catalog No. |
|----------|----------------|--------------|-----------------|
| 12 | 6 MT-RJ, Beige | Standard | FSPMTRJ6 |
| 16 | 8 MT-RJ, Beige | High-Density | FSPMTRJ8 |



FSPMTRJ6



FSPMTRJ8