

Center Spine Cable Tray

- 70 Straight Sections
- 72 Fittings & Connectors
- 74 Load Tables
- 75 Technical Data

Today's workspaces have rapidly evolving data, communications and security demands. Center Spine Cable Tray is an easily installed cable support system designed to provide safety, reliability and flexibility for future expansion. Field modifiable fittings combine to allow installers to easily maneuver cable pathways around obstructions and changes in elevation.

- Center spine style tray installs in half the time of conventional ladder tray.
- Cable can be loaded from one or two sides of the tray.
- Only half the hanging and joining material of conventional ladder tray are required.
- Allows for full cable visibility and requires less space for access.
- Can be hung as close to ceiling as code allows.

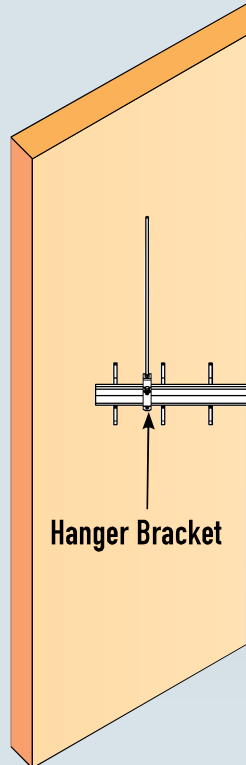

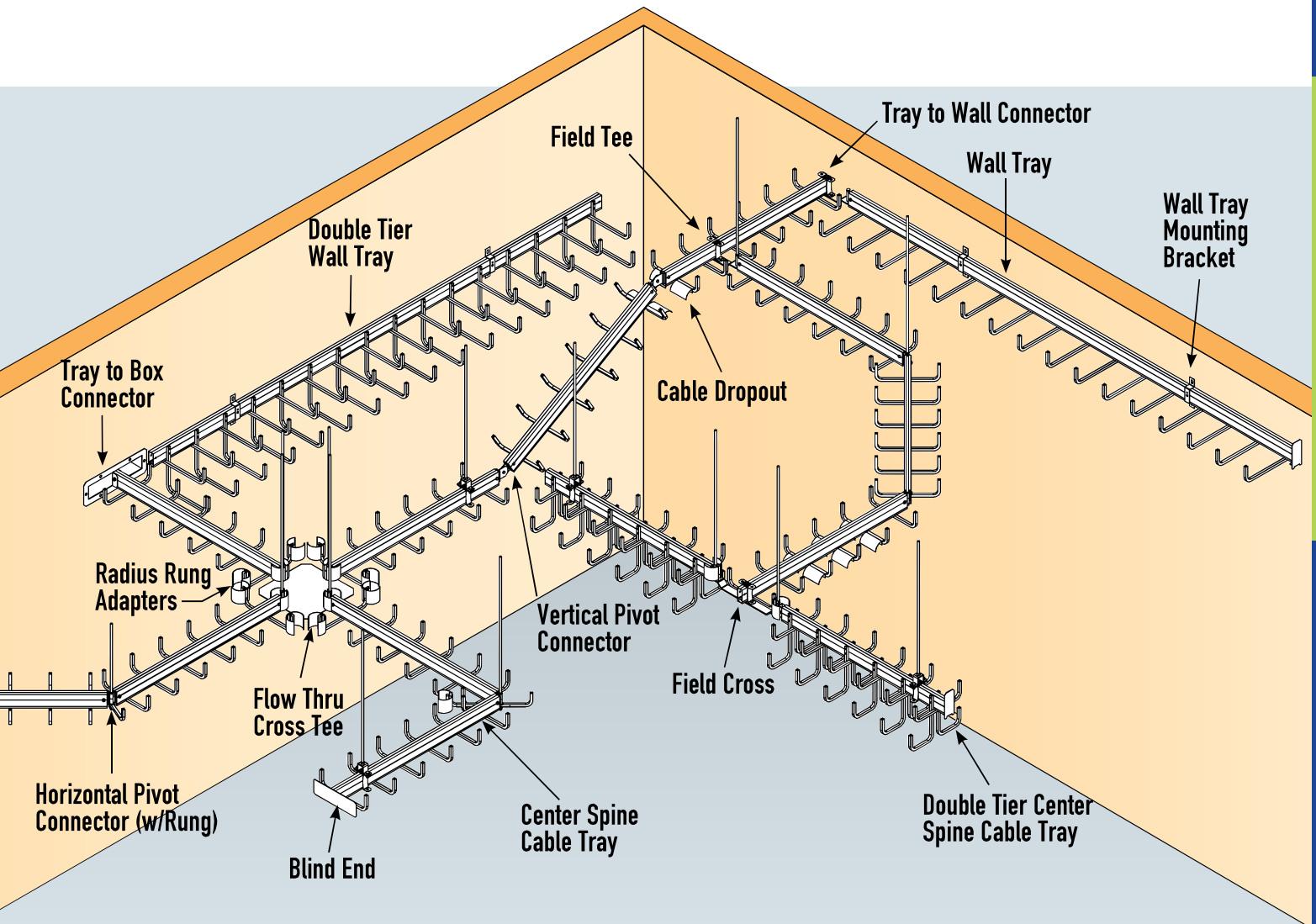

Cablofil Center Spine Cable Tray is designed with advanced features that make it a clear choice for design engineers and installers alike.

- **Cable bend radius control fittings.** Bend radius adapter and cable drop out fittings can be added to any installation to meet bend radius compliance standards. These parts meet the specifications for Fiber Optic and UTP/STP cabling and exceed TIA569 requirements.
- **3" center spine serves as a barrier between services.** The inherent design of center spine tray serves as a natural barrier separating one channel of the tray from the other.

Center Spine

Straight Sections — Single & Double Tier

CS CENTER SPINE SINGLE TIER

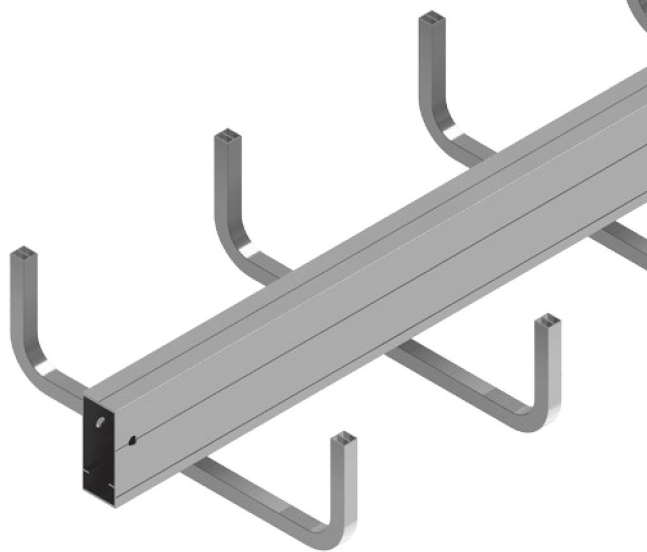

END VIEW

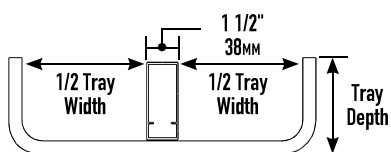

SIDE VIEW (SECTION)

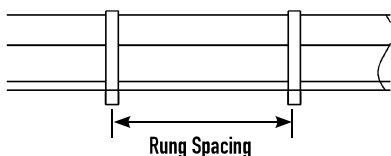

WS WALL SPINE SINGLE TIER

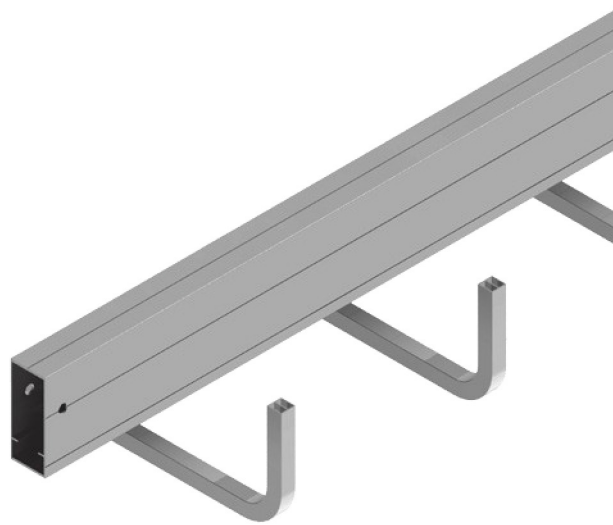

END VIEW

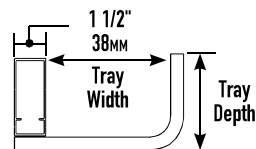

SIDE VIEW (SECTION)

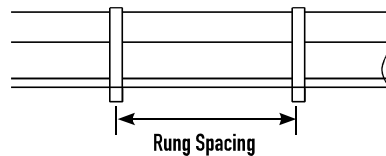

END VIEW OF RUNG

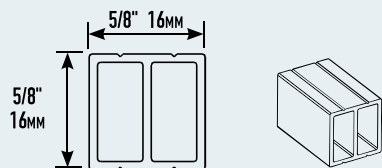

SINGLE TIER CATALOG NUMBERING EXAMPLE:

Series	CS	12	03	09	18	
CS	←	←	←	←	←	
WS	←	←	←	←	←	
Length	10 - 10' 3.0m	12 - 12' 3.6m				
Tray Depth	03 - 3" 76mm	04 - 4" 102mm	06 - 6" 152mm			
Rung Spacing		06 - 6" 152mm	09 - 9" 229mm	12 - 12" 305mm		
Tray Width*				06 - 6" 152mm	09 - 9" 229mm	12 - 12" 305mm
				18 - 18" 457mm**	24 - 24" 610mm**	

* Measured at inside of rungs as shown above. When ordering a tray 18" in width or larger, the use of a stiffener bar (CSSB) should be considered to stabilize eccentric loading.

**For CS only

CSDT CENTER SPINE DOUBLE TIER

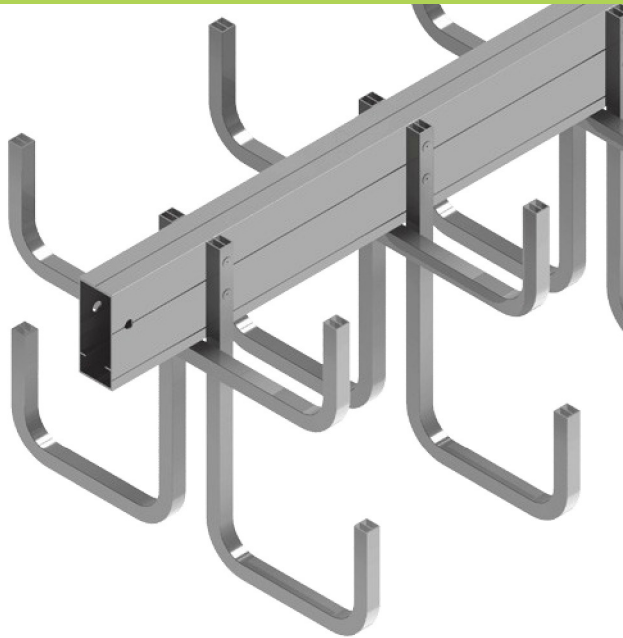

END VIEW

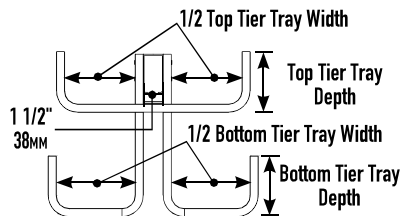

SIDE VIEW (SECTION)

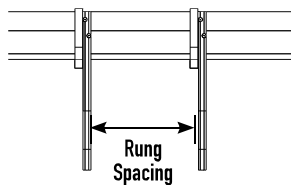

WSDT WALL SPINE DOUBLE TIER



END VIEW

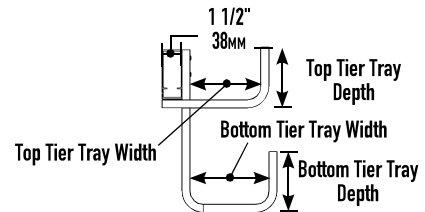

SIDE VIEW (SECTION)

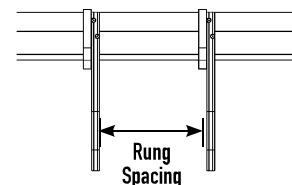

DOUBLE TIER CATALOG NUMBERING EXAMPLE:

Series	WSDT	10	3	4 [†]	09	18	12 [†]
CSDT							
WSDT							
		Length	Tray Depth	Rung Spacing			Tray Width*
		10 - 10' 3.0m	03 - 3" 76mm	06 - 6" 152mm			06 - 6" 152mm
		12 - 12' 3.6m	04 - 4" 102mm	09 - 9" 229mm			09 - 9" 229mm
			06 - 6" 152mm	12 - 12" 305mm			12 - 12" 305mm
							18 - 18" 457mm**
							24 - 24" 610mm**

[†] Second measurement refers to bottom tier.

* Measured at inside of rungs as shown above. When ordering a tray 18" in width or larger, the use of a stiffener bar (CSSB) should be considered to stabilize eccentric loading.

**For CSDT only

Center Spine

Fittings & Connectors

CSSC SPLICE CONNECTOR

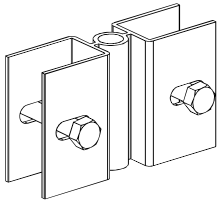

Allows the connection of any two pieces of CS/WS Series Tray. Hole in center accepts 1/2" threaded rod for hanging.

CSFT FIELD TEE

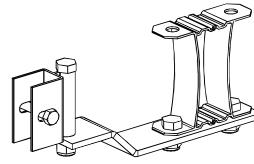

Used to make a tee (or "Y" turn) in the field for trays with any rung spacing. Specify tray width.

Rung Width

4	6	9	12	18	24	in
---	---	---	----	----	----	----

CATALOG NUMBERING EXAMPLE:

Product No. W
CSFT - 6

CSHP HORIZONTAL PIVOT CONNECTOR

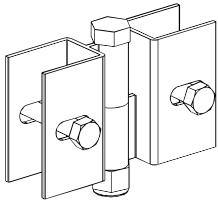

Allows any angle horizontal connection for all CS/WS Series Tray. For 90° or wider angles, the use of a Horizontal Pivot Connector with Rung is recommended.

CSFC FIELD CROSS

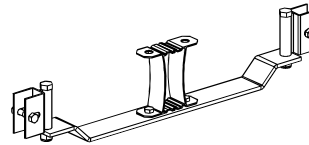

Used to make a cross in the field. For any rung spacing. Specify tray width.

Rung Width

4	6	9	12	18	24	in
---	---	---	----	----	----	----

CATALOG NUMBERING EXAMPLE:

Product No. W
CSFC - 6

CSHPR HORIZONTAL PIVOT CONNECTOR WITH RUNG

Provides additional cable support on horizontal connections for all CS/WS Series Tray. Can be used for any angle horizontal connection.

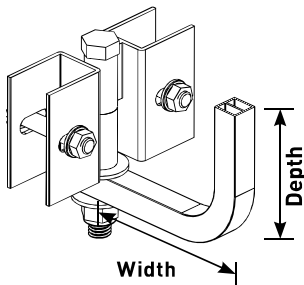

Rung Depth

3	4	6	in
---	---	---	----

Rung Width

4	6	9	12	18	24	in
---	---	---	----	----	----	----

CATALOG NUMBERING EXAMPLE:

Product No. D W
CSHPR - 3 - 18

CSFLT FLO-THRU CROSS TEE

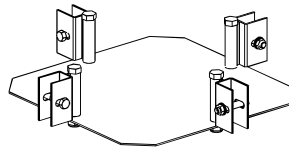

Tee, cross or "Y" turn with no barrier between channels.

CCSCP CONDUIT CONNECTOR

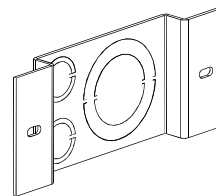

Connects conduit to tray. 1/2", 3/4", 1 1/4", and 2" trade size knockouts provided.

CSVP VERTICAL PIVOT CONNECTOR

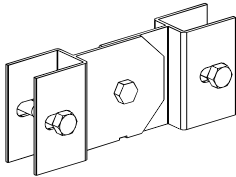

Allows for vertical bends for all CS/WS Series trays.

CSRA FIBERREADY 2" RADIUS RUNG ADAPTER

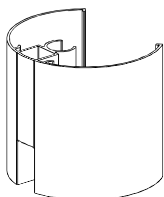

Slips onto any CS/WS Series rung and provides a 2" radius on either side for cable dropout protection or tee or cross transition.

CSJH J RUNG

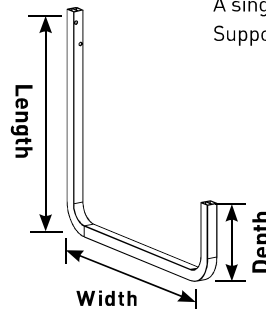

A single rung, bent in the shape of a "J". Supports cables on walls.

Rung Depth

3	4	6	in
---	---	---	----

Rung Width

4	6	9	12	in
---	---	---	----	----

Rung Length

6	8	in
---	---	----

CATALOG NUMBERING EXAMPLE:

Product No. D W L
CSJH - 3 - 6 - 8

CSGH G RUNG

A single rung, bent in the shape of a "G". Supports cables on walls and ceilings.

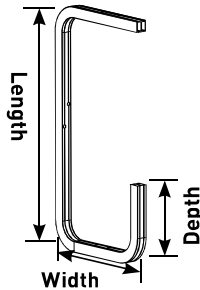

Rung Depth

3	4	6	in
---	---	---	----

Rung Width

4	6	9	12	in
---	---	---	----	----

Rung Length

6	8	in
---	---	----

CATALOG NUMBERING EXAMPLE:

Product No. D W L
CSGH-3-6-8

CSDO FIBER READY CABLE DROPOUT

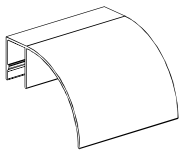

Extruded aluminum fitting provides a 2" cable bend radius for cables dropping out of all CS/WS Series trays.

Rung Width

3	4.5	6	9	12	in
---	-----	---	---	----	----

CATALOG NUMBERING EXAMPLE:

Product No. W
CSDO-6

CSHB HANGER BRACKET

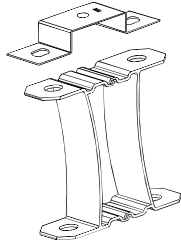

Provides support for the tray at any point other than at the splice connector without drilling. May also be used to develop seismic restraint – consult factory. Hole is pre-punched to accept 1/2" threaded rod.

CSEB BLIND END

Closes off the end of the tray.

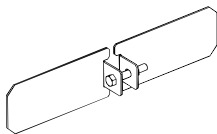

Rung Depth

3	4	6	in
---	---	---	----

Rung Width

6	9	12	18	24	in
---	---	----	----	----	----

CATALOG NUMBERING EXAMPLE:

Product No. D W
CSEB-3-18

CSTB TRAY-TO-BOX CONNECTOR

Provides a frame for cables entering the tray from or through a wall.

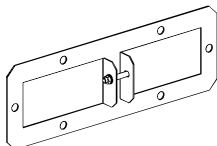

Rung Depth

3	4	6	in
---	---	---	----

Rung Width

6	9	12	18	24	in
---	---	----	----	----	----

CATALOG NUMBERING EXAMPLE:

Product No. D W
CSTB-X-8

CSTW TRAY-TO-WALL CONNECTOR END CAP

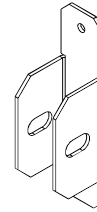

Connects tray to wall.

CSFS FLOOR SUPPORT BRACKET

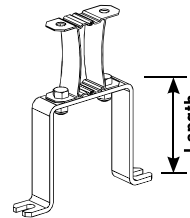

Provides support for trays used in raised floor applications.

Note: Must specify distance (X) from floor to tray bottom.

CATALOG NUMBERING EXAMPLE:

Product No. L

CSFS-X

CSSB STIFFENER BAR

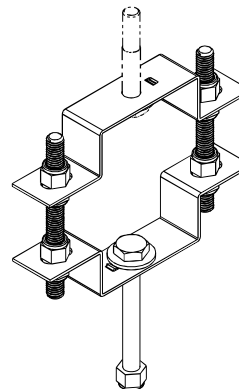

Provides additional support to offset eccentric loading.

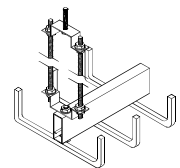
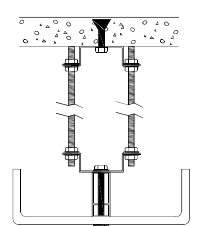

CSDS DIVIDER STRIP

Creates cable barrier for additional organization. Specify rung depth. All strips come in 12' sections.

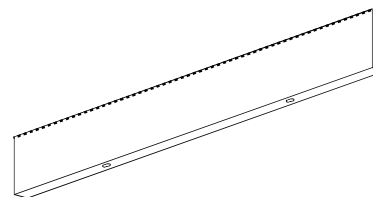

Rung Depth

3	4	6	in
---	---	---	----

CATALOG NUMBERING EXAMPLE:

Product No. D
CSDS-6

Center Spine

Load Tables

CENTER SPINE CABLE TRAY WIRE FILL CAPACITY – 3" [76mm] TALL RUNG

CABLE/ WIRE TYPE	CABLE/ WIRE SIZE	O.D.		NUMBER OF WIRES (HEIGHT x WIDTH)				
		INCHES	MM	3x6	3x9	3x12	3x18	3x24
UNSHIELDED TWISTED PAIR	2-pair, 24 AWG	0.150	3.8	508	763	1017	1525	2034
	4-pair, 24 AWG, Cat 3	0.190	4.8	317	475	634	951	1268
	4-pair, 24 AWG, Cat 5e	0.210	5.3	260	390	520	780	1039
	4-pair, 24 AWG, Cat 6	0.250	6.4	183	275	367	550	733
	4-pair, 24 AWG, Cat 6a	0.354	9.0	91	137	183	274	366
	25-pair, 24 AWG	0.360	9.0	88	133	177	265	354
COAXIAL	RG6/U	0.270	7.0	157	236	314	471	628
FIBER OPTIC	2-Strand (Zip Cord)	0.118x0.236	3x6	323	485	646	970	1293
	Round 4 Strand Fiber	0.187	4.7	328	492	655	983	1311
	Round 6 Strand Fiber	0.256	6.5	175	262	350	525	699

CENTER SPINE CABLE TRAY WIRE FILL CAPACITY – 4" [102mm] TALL RUNG

CABLE/ WIRE TYPE	CABLE/ WIRE SIZE	O.D.		NUMBER OF WIRES (HEIGHT x WIDTH)					
		INCHES	MM	4x6	4x9	4x12	4x18	4x19	4x24
UNSHIELDED TWISTED PAIR	2-pair, 24 AWG	0.150	3.8	678	1017	1356	2034	2034	2712
	4-pair, 24 AWG, Cat 3	0.190	4.8	423	634	845	1268	1268	1690
	4-pair, 24 AWG, Cat 5e	0.210	5.3	346	520	693	1039	1039	1386
	4-pair, 24 AWG, Cat 6	0.250	6.4	244	367	489	733	733	978
	4-pair, 24 AWG, Cat 6a	0.354	9.0	122	183	244	366	366	488
	25-pair, 24 AWG	0.360	9.0	118	177	236	354	354	472
COAXIAL	RG6/U	0.270	7.0	209	314	419	628	628	838
FIBER OPTIC	2-Strand (Zip Cord)	0.118x0.236	3x6	431	646	862	1293	1293	1724
	Round 4 Strand Fiber	0.187	4.7	437	655	874	1311	1311	1748
	Round 6 Strand Fiber	0.256	6.5	233	350	466	699	699	933

CENTER SPINE CABLE TRAY WIRE FILL CAPACITY – 6" [152mm] TALL RUNG

CABLE/ WIRE TYPE	CABLE/ WIRE SIZE	O.D.		NUMBER OF WIRES (HEIGHT x WIDTH)				
		INCHES	MM	6x6	6x9	6x12	6x18	6x24
UNSHIELDED TWISTED PAIR	2-pair, 24 AWG	0.150	3.8	1017	1525	2034	3051	4068
	4-pair, 24 AWG, Cat 3	0.190	4.8	2353	951	1268	1901	2535
	4-pair, 24 AWG, Cat 5e	0.210	5.3	2079	780	1039	1559	2079
	4-pair, 24 AWG, Cat 6	0.250	6.4	1467	550	733	1100	1467
	4-pair, 24 AWG, Cat 6a	0.354	9.0	732	274	366	549	732
	25-pair, 24 AWG	0.360	9.0	707	265	354	530	707
COAXIAL	RG6/U	0.270	7.0	1257	471	628	942	1257
FIBER OPTIC	2-Strand (Zip Cord)	0.118x0.236	3x6	2585	970	1293	1939	2585
	Round 4 Strand Fiber	0.187	4.7	2622	983	1311	1966	2622
	Round 6 Strand Fiber	0.256	6.5	1399	525	699	1049	1399

NOTE: Values are based on fill capacity only – cable weights must also be checked to ensure that load capacity of the tray is not exceeded. Fill values are based on NEC fill requirement stating a maximum allowable fill of 50% of tray cross sectional area. In reality, this is a fully loaded tray due to spaces between cables.

Technical Data

NEMA LOAD/SPAN DESIGNATIONS		
NEMA CLASS	SUPPORT SPAN	WORKING LOAD*
12A	12 ft.	50 lb./ft.
12B	12 ft.	75 lb./ft.
12C	12 ft.	100 lb./ft.

* The working load is the total weight of all cables and tubing to be placed in the tray.

CSA LOAD CLASS CAPACITIES AT VARYING SUPPORT SPACINGS				
CSA CLASS	SUPPORT SPACING			
	1.5m	2.0m	2.5m	3.0m
	WORKING LOAD*			
A	99kg/m	62kg/m	45kg/m	37kg/m
C1	259kg/m	164kg/m	119kg/m	97kg/m
D1	N/A	N/A	N/A	179kg/m
E	N/A	N/A	N/A	299kg/m

Standard Material
Cable Tray Spine, Rungs and Fittings: 6063T6 Aluminum Alloy Liners and Covers: 5052 Aluminum Alloy
Third Party Certifications
UL File No. E140705

Member of:



All CS12 series Cable Trays are NEMA 12C Rated, CSA C1 Rated.
All CS10 Series Cable Trays are NEMA 10C Rated, CSA C1 Rated.

When designing, specifying or installing a cable tray system, please consider the following (from the Canadian Electrical Code, Appendix B 12-2202):

- Some fittings (particularly horizontal elbows) may require additional support depending on the loading.

Per NEMA Standard Publication VE-1, Cable Tray is designed as a support for power or control cables, or both, and is not intended or designed to be a walkway for personnel. The user is urged to display appropriate warnings against the use of this support as a walkway. Each section of tray has a warning label.