

Pre-loaded fiber drawers provide a pre-configured, ready-to-install system for managing fiber optic terminations. The pre-loaded enclosure is a two-piece design with a slide-out drawer for full access to all fiber terminations and easy installation. The fiber drawer has integral mounting brackets suitable for installation in any 19" wide EIA-310/IEC 60297 compatible rack or cabinet.



technical information

Dimensions:	1.73"H x 17.5"W x 12.13" D (43.9 x 444.5 x 308.2mm)
Mounting option:	Integral brackets mount to 19" wide EIA-310/IEC 60297 compatible rack or cabinet
Accessories:	Mounting hardware and fiber routing accessory kit included; contains two FMS1 fiber management spools, two 30mm size rubber grommets, one PG11 cable gland, Panduit® Pan-Ty® Cable Ties and #12-24 and M6 x 1 mounting screws

key features and benefits

Pre-loaded with fiber optic adapters	Factory configured with duplex SC or LC adapters for fast and easy cabling and installation
Slide out drawer	Slides forward a full 300mm for easy service access to all fiber terminations, connections and splices
Multiple cable entry methods	Trunk and interconnect cable entry via PG11 glands, 5mm blown fiber glands, 20mm knockouts or 30mm rubber grommets
Two-piece, all metal body construction	Simple and economical installation with no loose components to misplace; improved protection over plastic fiber drawers
Dedicated labeling areas	Silk-screened white labeling areas for individual fiber channel identification plus overall enclosure labeling

applications

- Provides a ready-to-install system for managing fiber optic terminations, connections and patching in a variety of applications
- Can serve as a transition from backbone cabling to distribution switching in telecommunication rooms, an interconnect to active equipment switches in a fiber to the zone application and can be used as a transition enclosure for splicing to service provider trunks then patching to premise intra-building cabling
- Pre-loaded with SC or LC style adapters suitable for use with 50/125µm (OM2 or OM3) multimode, 62.5/125µm (OM1), or OS1/OS2 singlemode fiber
- Can terminate and manage up to 48 fibers in 1 RU depending on configurations and adapter type



NetKey® Pre-Loaded Fiber Drawer for OM1 62.5/125µm Multimode Fiber

- 6 duplex SC adapters: NKFD1W6EIDSC
- 12 duplex SC adapters: NKFD1W12EIDSC
- 12 duplex LC adapters: NKFD1W12EIDL
- 24 duplex LC adapters: NKFD1W24EIDL

NetKey® Pre-Loaded Fiber Drawer for OM2 50/125µm Multimode Fiber

- 6 duplex SC adapters: NKFD1W6BLDSC
- 12 duplex SC adapters: NKFD1W12BLDSC
- 12 duplex LC adapters: NKFD1W12BLDL
- 24 duplex LC adapters: NKFD1W24BLDL

NetKey® Pre-Loaded Fiber Drawer for OM3 50/125µm Multimode Fiber

- 6 duplex SC adapters: NKFD1W6AQDSC
- 12 duplex SC adapters: NKFD1W12AQDSC
- 12 duplex LC adapters: NKFD1W12AQDL
- 24 duplex LC adapters: NKFD1W24AQDL

NetKey® Pre-Loaded Fiber Drawer for OS1/OS2 9/125µm Singlemode Fiber

- 6 duplex SC adapters: NKFD1W6BUDSCZ
- 12 duplex SC adapters: NKFD1W12BUDSCZ
- 12 duplex LC adapters: NKFD1W12BUDLCZ
- 24 duplex LC adapters: NKFD1W24BUDLCZ

Splicing Accessories

- Fiber splice module, 24 fusion splices: FOSMF
- Fiber splice module, 12 mechanical splices: FOSMM
- Fiber splice chip, 24 fusion splices: FSC24

NetKey® Pre-Loaded Fiber Drawers

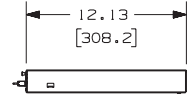
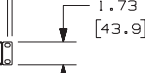
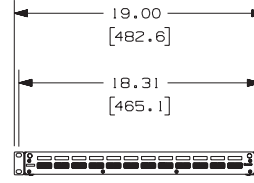
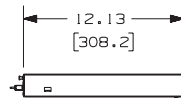
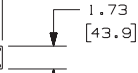
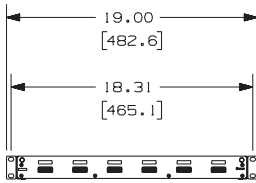
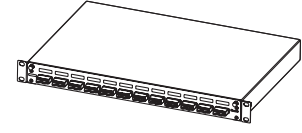
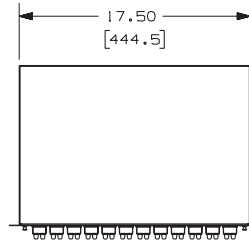
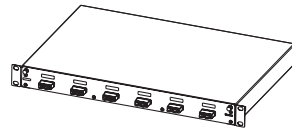
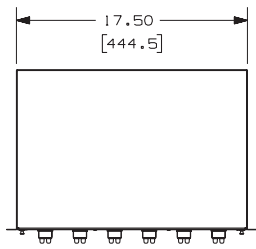

NKFD1W6DSC**

NKFD1W12DSC**

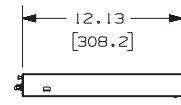
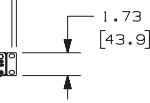
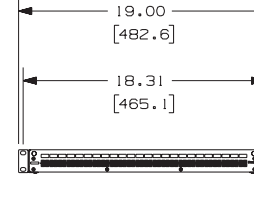
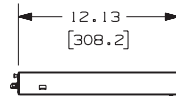
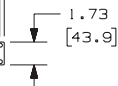
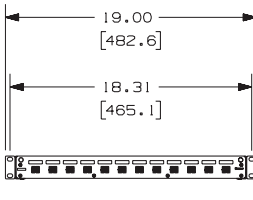
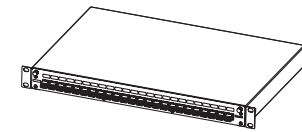
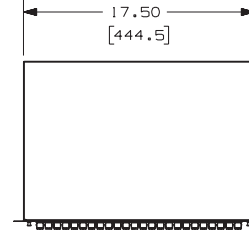
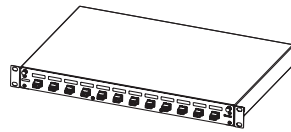
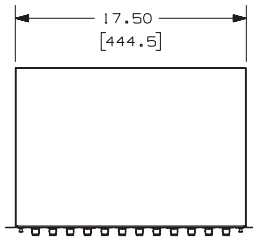

NKFD1W12DLC**

NKFD1W24DLC**



Dimensions are in inches. [Dimensions in brackets are metric].

WORLDWIDE SUBSIDIARIES AND SALES OFFICES

PANDUIT CANADA
Markham, Ontario
cs-cdn@panduit.com
Phone: 800.777.3300

PANDUIT EUROPE LTD.
London, UK
cs-emea@panduit.com
Phone: 44.20.8601.7200

PANDUIT SINGAPORE PTE. LTD.
Republic of Singapore
cs-ap@panduit.com
Phone: 65.6305.7575

PANDUIT JAPAN
Tokyo, Japan
cs-japan@panduit.com
Phone: 81.3.6863.6000

PANDUIT LATIN AMERICA
Jalisco, Mexico
cs-la@panduit.com
Phone: 52.33.3777.6000

PANDUIT AUSTRALIA PTY. LTD.
Victoria, Australia
cs-aus@panduit.com
Phone: 61.3.9794.9020

For a copy of Panduit product warranties, log on to www.panduit.com/warranty

For more information

Visit us at www.panduit.com

Contact Customer Service by email: cs@panduit.com
or by phone: 800-777-3300 and reference NKDS19

©2010 Panduit Corp.
ALL RIGHTS RESERVED.

WW-NKDS19

2/2010