

FLUSH BRASS
Delivery Systems
3 Service: Power & Voice/Data
UL Listed

HUBBELL

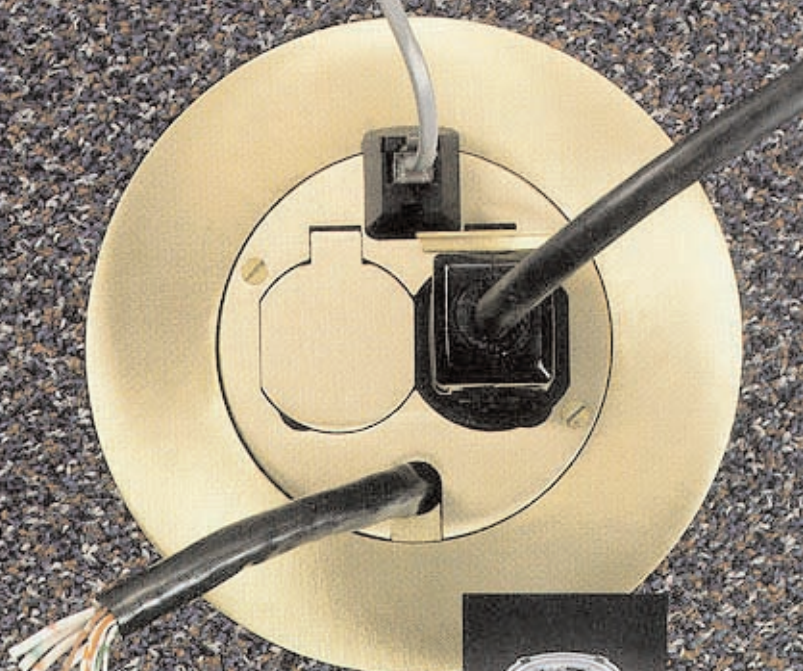

Fire-Rated Poke-Through



Plastic Floor Box

Finally, all-brass 3 service capability in a single flush service fitting. Hubbell has expanded its line of Flush Delivery Systems to include deluxe brass covers for fire-rated poke-throughs and plastic floor boxes. Previously, the only 3 service solution to this requirement was multi-gang floor boxes and several brass covers. Now Hubbell combines the elegance of brushed brass and the flush delivery of power and voice/data. Why go to 3 gangs of brass for power and voice/data, when you can accomplish this with one Hubbell service fitting?

Hubbell also gives you 3 service options within its brass family:

- Flush brass fire-rated poke-through (with standard duplex receptacle or isolated ground receptacle)
- Flush brass cover for plastic floor box (select your own receptacle: standard duplex, isolated ground, 15A Twist-Lock™)

When you need to combine elegance with 3 service capability, the choice is Hubbell Brass Delivery Products.

FEATURES

Brushed brass cover and matching carpet flange

Flush brass service fittings are provisioned for 3 services

Covers have spring-loaded duplex flaps

Poke-through and plastic floor box covers have a uniform look

Equipped with 2 versatile low-voltage knockouts

BENEFITS

Provides an elegant, pure brass look, unlike inferior brass plated or painted offerings.

Power and voice/data in one unobtrusive unit.

Self-closing flaps keep debris out of receptacle, reduce trip hazards, and prevent breakage.

Mix and match as required and maintain a consistent appearance: plastic floor box on grade level, poke-through for above grade.

Outfit these brass units with the bushed opening provided for voice/data cabling or opt for the low-profile modular jacks.

Sold by:



FLUSH BRASS DELIVERY SYSTEMS

Technical Data

FIRE-RATED POKE-THROUGH

PLASTIC FLOOR BOX

DIMENSIONAL DATA

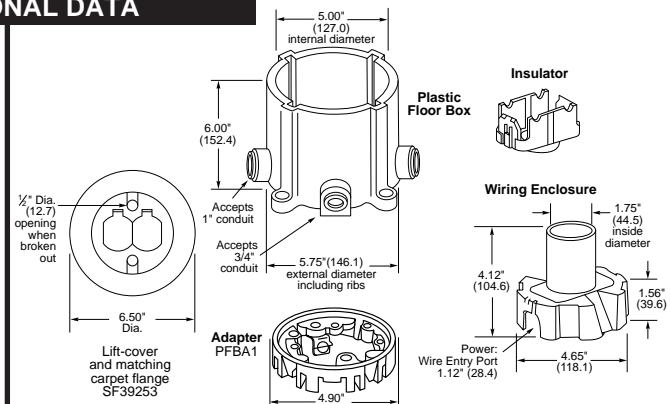
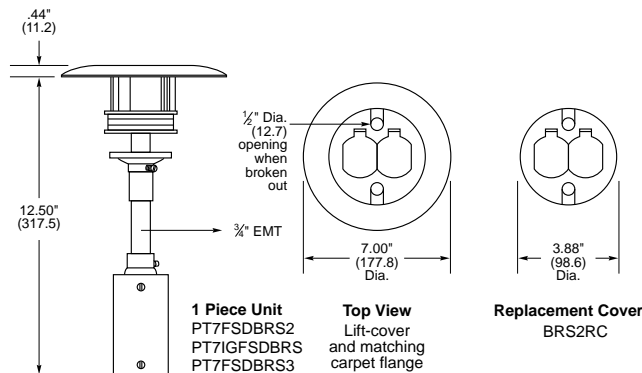

INSTALLATION INFORMATION

Mounting	3 inch diameter hole through a concrete floor
Floor Thickness Range	2 1/4 - 7 inches
Fire Rating	1-4 hours
Floor Surface	These poke-through products are recommended for use on carpeted floors.
Finish	Brushed brass cover and matching carpet flange.
Low-voltage Capacity	Each low-voltage opening (2 total) can accommodate up to (1) 25 pair voice/data cable or (4) 8 conductor voice/data cables or (1) Tj8 low-profile modular jack. <i>Note: Each unit provided with (2) low-voltage bushings to handle small diameter cables.</i>
Power	Prewired 20A duplex receptacle.

Mounting	On a PFB1 plastic floor box set in concrete. Requires a PFBA1 adapter and a PFBT1 low-voltage divider.
Depth of Pour Floor Surface	Minimum of 3 inches. SF39253 cover is recommended for use on carpeted floors.
Finish	Brushed brass cover and matching carpet flange.
Low-voltage Capacity	Same as poke-through listed on left.
Power	Not prewired, order devices as required.

UL DATA

UL Listing Number	232A
Hubbell's UL File Number	Outlet boxE31999
	Fire ResistanceR8429
UL Spacing Restrictions	Minimum of 2 ft. O.C. and not more than one unit per each 65 sq. ft. of floor area in each span.

UL Listing Number	17C6
Hubbell's UL File Number	E31999

ORDERING INFORMATION

Fire-Rated Poke-Throughs	Description
Cat. No.	One-Piece Units
PT7FSDBR2	Includes through-floor fitting and a flush all-brass service fitting (lift-cover insert and carpet flange). Equipped with a prewired 5352 black receptacle and (2) low-voltage knockouts.
PT71GFSDBRS	Same as PT7FSDBR2 except prewired with an isolated ground receptacle (IG5362).
PT7FSDBR3	Includes through-floor fitting and a flush service fitting. Equipped with a prewired 5352 black receptacle, a brass carpet flange, and a black plastic lift-cover insert.
	Two-Piece Units
FRFBR2	All-brass lift-cover insert and matching carpet flange. Prewired with a 5352 black receptacle and provisioned with (2) low-voltage knockouts. (Used with PT7FSD or PT73SD through-floor fittings.)

Fire-Rated Poke-Throughs (cont'd)	Description
Cat. No.	Through-floor fitting (with junction box).
PT7FSD	
PT73SD	Through-floor fitting (without junction box).

Plastic Floor Box	Description
Cat. No.	3 service flush brass service fitting. Includes a brass lift-cover insert, matching carpet flange, (2) low-voltage knockouts (excludes receptacle). Note: Each SF39253 requires the following products:
SF39253	
PFB1	Round plastic floor box (PVC)
PFBA1	Adapter ring
PFBT1	Low-voltage divider

Accessories (Poke-Through & Plastic Floor Box)

Replacement Covers	Description
Cat. No.	
BRS2RC	Brass insert cover (with low-voltage knockouts). Excludes carpet flange and receptacle. Use as a replacement cover for PT7FSDBR2, PT7IGFSDBRS, FRFBR2, and SF39253.
PFBRCBL	Black plastic insert cover (with low-voltage knockouts). Excludes carpet flange and receptacle. Use as a replacement cover for PT7FSDBR3.

Low-Profile Modular Jacks (Use up to 2 jacks per service fitting)

Cat. No.	Description
TJ8	Modular jack accessory: 8 position/8 wire (AT&T, EIA568B) with prewired 15" leads, includes dust cover. Color: Black



Wiring Device - Kellems

Hubbell Incorporated (Delaware) • 185 Plains Road • Milford, CT 06460-2420 • (203) 882-4800 • FAX (800) 255-1031
World Wide Web URL: <http://www.hubbell-wiring.com>