

## Ophera Video Entry System Video Distribution & Amplification Modules



### APPLICATION

The Ophera Video Entry system integrates high quality color video and audio components in a stylish combination intended to complement any décor. A wide range of appealing and innovative features makes Ophera the recognized choice for moderate sized MDU and custom residential projects. The system operates independent of data networks using proven analog technology.



BC200-4VD

### FEATURES

- Video distribution module (BC200-4VD) distributes the modulated video signal over 4 lines without requiring power.
- Amplified video distribution module (BC200-AVD) distributes modulated video signal over 4 lines without any signal loss. Power supply required.
- Video amplifier module (BC200-AMP) amplifies video signal by 6 dB in the bus or 20dB in the branch to compensate for losses experienced by video distributors.

### DESIGN CONSIDERATIONS

- One video amplifier module (BC200-AMP) required for every 10 distribution modules (BC200-4VD or BC200-AVD)
- Maximum of 30 video distribution modules (BC200-4VD and BC200-AVD) per system
- Passive modules (BC200-4VD, BC200-AMP) require no power
- Amplified video distribution module (BC200-AVD) requires power from BC100-VAS

### STANDARDS COMPLIANCE

Meets or exceeds all applicable standards:

- CE
- FCC Part 15

### COUNTRY OF ORIGIN

Italy

### WARRANTY INFORMATION

For a copy of Leviton product warranties, visit [www.leviton.com](http://www.leviton.com).

BC200-xVD, BC200-AMP

### TECHNICAL SPECIFICATIONS

#### Electrical (BC200-4VD)

Pass-through video loss	0.6 dB input/output
Video attenuation	20 dB per branch

#### Electrical (BC200-ADV)

Supply Voltage	14-18 VDC
Current Demand	60 mA
Pass-through video loss	0.6 dB input/output

#### Electrical (BC200-AMP)

Current Demand	<20 mA
----------------	--------

#### Dimensions

BC200-4VD	2.63" x 1.92" x 0.63" (62mm x 49mm x 16mm)
BC200-AVD	4.13" x 4.15" x 2.48" (105mm x 145mm x 63mm)
BC200-AMP	2.63" x 1.92" x 0.63" (62mm x 49mm x 16mm)

#### Environmental

Operating Temperature	32° F to 95° F (0° C to 35° C)
-----------------------	--------------------------------

### PART NUMBERS

Description	Part No.
Video distribution module, 4 output	BC200-4VD
Amplified video distribution module, 4 output	BC200-AVD
Video amplifier module	BC200-AMP

**ELECTRONIC FILES**

For CAD files, typical specs, or technical drawings (.DXF, .DWG, Visio), visit [www.leviton.com](http://www.leviton.com).

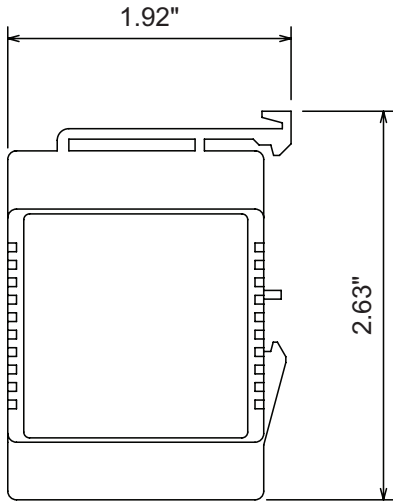

BC200-4VD, BC200-AMP

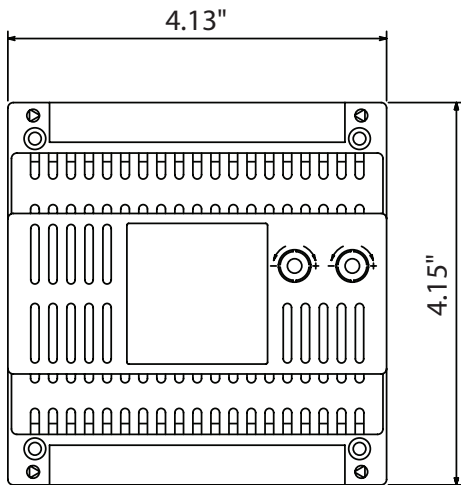
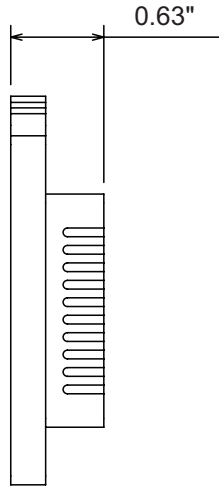

BC200-AVD

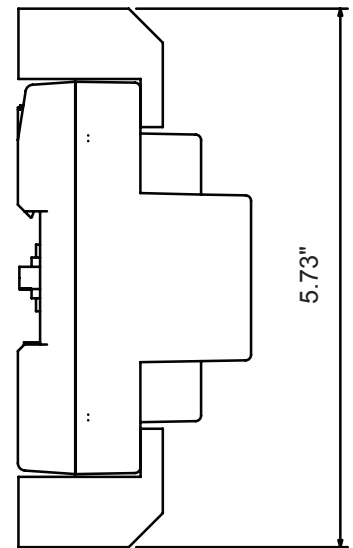
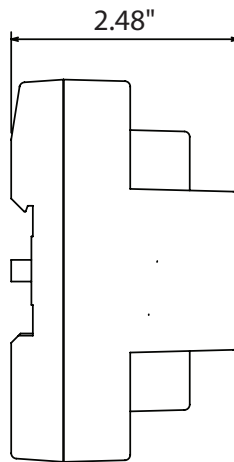

BC200-AVD w/ screw covers

BC200-xVD, BC200-AMP