

Catalog Number

Fittings

Internal Elbow

Full capacity 1¼ in. bend radius internal elbow.

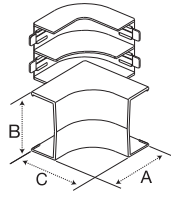

Cover Only

PW2IE
 A: 2.83" (71.88)
 B: 2.32" (58.93)
 C: 2.83" (71.88)

Base & Cover

PW2IEBC
 A: 2.83" (71.88)
 B: 2.32" (58.93)
 C: 2.83" (71.88)

Office
White

External Elbow

Full capacity 1¼ in. bend radius external elbow.

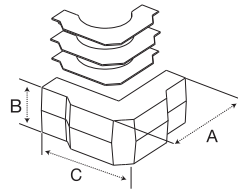

PW2EE
 A: 5.00" (127.00)
 B: 2.32" (58.93)
 C: 5.00" (127.00)

PW2EEBC
 A: 5.00" (127.00)
 B: 2.32" (58.93)
 C: 5.00" (127.00)

Office
White

Flat Elbow

Full capacity 1¼ in. bend radius flat elbow.

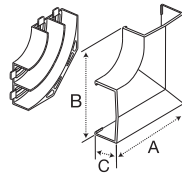

PW2FE
 A: 3.94" (100.08)
 B: 3.94" (100.08)
 C: 1.11" (28.19)

PW2FEBC
 A: 3.94" (100.08)
 B: 3.94" (100.08)
 C: 1.11" (28.19)

Office
White

Tee

Full capacity 1¼ in. bend radius tee.

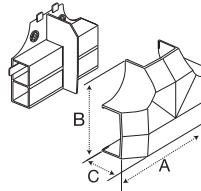

PW2TC
 A: 5.42" (137.67)
 B: 3.91" (99.31)
 C: 1.90" (48.26)

PW2TCBC
 A: 5.42" (137.67)
 B: 3.91" (99.31)
 C: 1.90" (48.26)

Office
White

Splice Cover

For covering potential openings where two lengths of raceway come together.

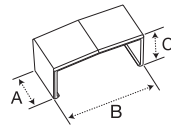

PW2SC
 A: 1.11" (28.19)
 B: 2.30" (58.42)
 C: 1.11" (28.19)

Office
White

Safety Strap

For preventing potential tampering with PW2 WallTrak cover. Can also be used as a splice cover.

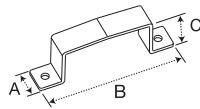

PW2SS
 A: 0.62" (15.75)
 B: 3.43" (87.12)
 C: 1.12" (28.45)

Office
White

End Cap

For closing end of PW2 WallTrak Raceway.

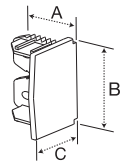

PW2EC
 A: 1.00" (25.40)
 B: 2.14" (54.36)
 C: 1.04" (26.42)

Office
White

Reducer

Reduces from PW2 WallTrak Raceway to one or two PP1 PremiseTrak Raceway(s).

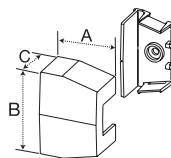

PW2RED
 A: 1.62" (41.15)
 B: 2.40" (60.96)
 C: 1.15" (29.21)

Office
White

Conduit Adapter/Ceiling Fitting

For connecting conduit to raceway. Also use for ceiling feeds. Has combination ½ in., ¾ in. and 1 in. trade size KOs.

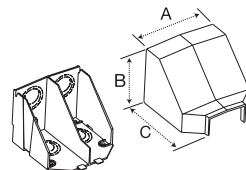

PW2CACF
 A: 4.18" (106.17)
 B: 3.32" (84.33)
 C: 4.20" (106.68)

Office
White