



## Reasons to choose the JABRA BT4010

Smart Display. Easy to Use. Ideal for All-day Talk

[www.jabra.com](http://www.jabra.com)

A BRAND BY



## Features and Specifications

1. Smart Display featuring battery status indicator, Bluetooth connection indicator and call indicator.
2. Easy to use - clear sound and 3 button operation.
3. Ideal for all day talk - up to 6 hours talk time and up to 150 hours standby time
4. Wear with or without the earhook - two sizes are provided for individual comfort
5. Discreet wearing style without flashing lights
6. Weighs approximately 10g
7. L49 mm x W17 mm x H27,9 mm (L 1.93 x W 0.67 x H 1.1 in)
8. Auto-pairing for no-nonsense set-up
9. Features answer/end, redial and voice dial\*
10. Bluetooth technology - clear conversations with Bluetooth 2.0 EDR & eSCO
11. Charging plug: Micro USB, 5-pin



Datasheet\_MD4\_BT4010\_01\_03/08

\* Phone dependent

### Freephone customer support numbers:

Denmark	Phone: 70252272	E-mail: <a href="mailto:support.no@jabra.com">support.no@jabra.com</a>
Finland	Phone: 00800 722 52272	E-mail: <a href="mailto:support.no@jabra.com">support.no@jabra.com</a>
Italy	Phone: 800 786543	E-mail: <a href="mailto:support.it@jabra.com">support.it@jabra.com</a>
Norway	Phone: 800 61272	E-mail: <a href="mailto:support.no@jabra.com">support.no@jabra.com</a>
Spain	Phone: 900 984 542	E-mail: <a href="mailto:support.es@jabra.com">support.es@jabra.com</a>
Sweden	Phone: 020792522	E-mail: <a href="mailto:support.no@jabra.com">support.no@jabra.com</a>
UK	Phone: 0800 0327026	E-mail: <a href="mailto:support.uk@jabra.com">support.uk@jabra.com</a>

© 2008, GN Netcom A/S. All rights reserved. Jabra® is a registered trademark of GN Netcom A/S. All other trademarks included herein are the property of their respective owners. The Bluetooth® word mark and logos are owned by the Bluetooth SIG, Inc. and any use of such marks by GN Netcom A/S is under license. (Design and specifications subject to change without notice)

# Jabra



## Smart Display

Bluetooth® just got easier

Always know your:

Battery Status Connection Status Call Status

[www.jabra.com](http://www.jabra.com)



## The Smart Way to Talk

Bluetooth just got easier and more intuitive with a Smart Display.

Jabra's BT4010 offers a new level of usability for Bluetooth headsets. With the BT4010, there's no need for guesswork or interpreting flashing lights. With one glance, you can easily see your battery level, if your headset is connected and if you're 'on the call'.

Small in size but big on design and user friendliness - the BT4010 offers long talk time and crystal clear sound. With auto-pairing and instant connections, the BT4010 can be up and running within a matter of seconds.

BT4010's stylish design removes 'unsightly flashing lights', giving BT4010 an understated, professional look. Wear this headset with or without the earhook - it's your choice.

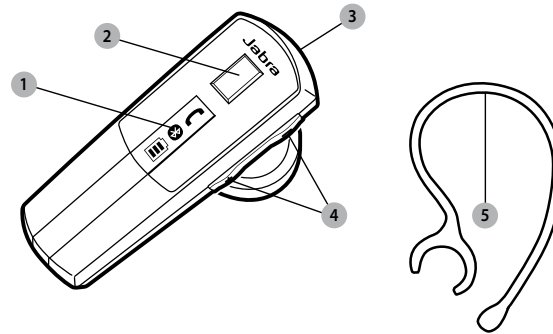

### 1) LCD display

With battery, Bluetooth and call indicator

### 2) Answer/end button

Press and hold to turn the headset on and off. Tap to answer/end a call.

### 3) Charger socket

Easy charging with AC power supply provided

### 4) Volume buttons

Tap the volume up or down to adjust the volume

### 5) Earhook

Easy clip-on earhook in two different sizes

## Quick start guide

### How the display works

The display shows battery indicator, Bluetooth indicator and call indicator.



### Charging your headset

The headset is fully charged when three battery levels are constantly shown.

### Turning your headset on and off

Press and hold the answer/end button to turn on your headset. When the battery icon flashes, the headset is turned on/off.

### Pairing the headset with your phone

1. When you turn on your Jabra headset for the first time, the headset will automatically start up in pairing mode. The Bluetooth indicator flashes
2. Activate Bluetooth on the phone
3. Press 'Yes' or 'OK' on the phone and confirm with PIN code 0000 (4 zeros)
4. Your phone will confirm when the pairing is complete
5. For later pairing: Turn your headset off. Press and hold for 5 seconds until Bluetooth indicator flashes

### Using your headset

Tap the answer/end button on your headset to answer a call. To end a call, just tap the answer/end button again.

### Wearing style

Wear the Jabra BT4010 with or without an earhook. To wear it with earhook, click it on for right or left ear wearing.