

HUBBELL

Your Single Source Solution Is Hubbell's Total Delivery System

MULTI-CONNECT Recessed Wall Boxes

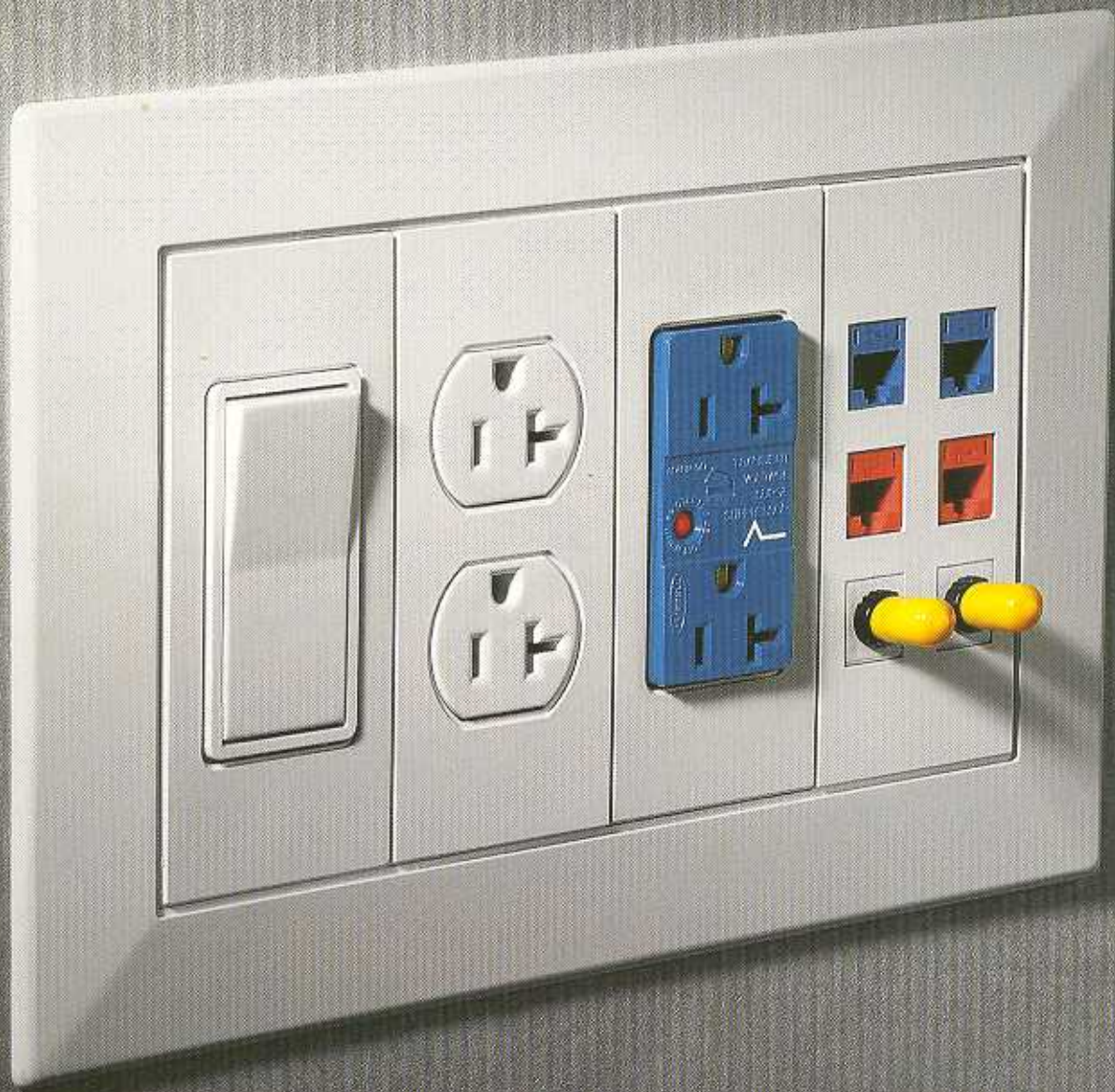

*It's a snap...
installing the future....
with Hubbell*



Wiring Device-Kellems

MULTI-CONNECT - Recessed Wall Boxes



"In The Wall" Solutions ><<

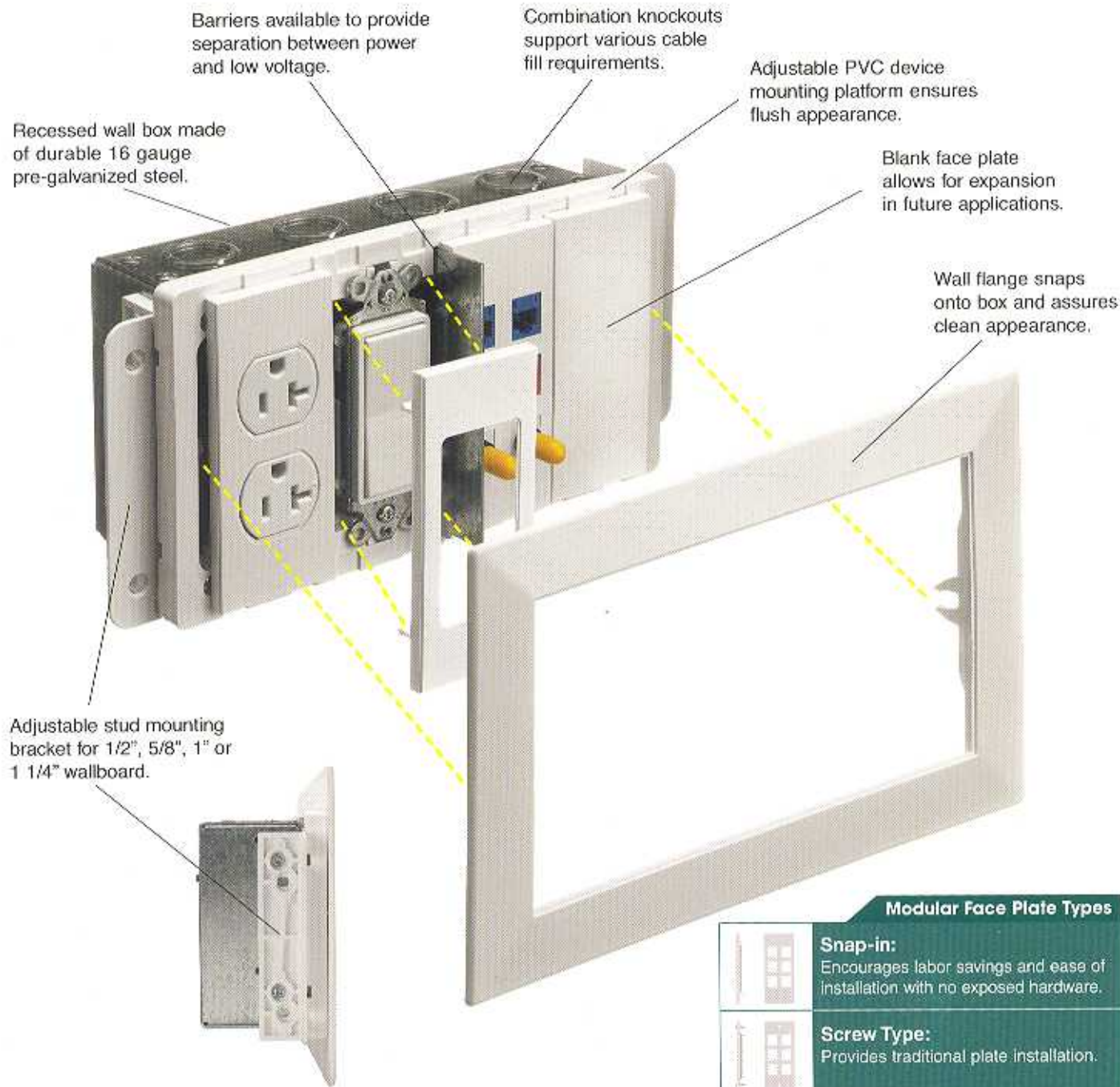

With Hubbell...

It's a snap.... to reduce labor costs and allow for expansion in future installations. Multi-Connect's "in the wall" versatility accommodates multi-service applications and is unparalleled when combined with the highest quality wiring devices in the industry. Utilize the one, two, four and six gang recessed wall boxes to provide secure connections for voice, data, fiber-optics and power. Insert an assortment of modular faceplates and wall flanges to match your interior decor. Other Hubbell Delivery System alternatives include Floor Boxes, Fire-Rated Poke-Throughs, Service Poles and Non-metallic Raceway products. So remember, regardless of installation requirements, Hubbell remains your single source solution.

MULTI-CONNECT - Recessed Wall Boxes



Ordering Information



Follow steps one, two and three below to easily identify the appropriate wall box, modular face plates and wall flanges you need. Maximize your ability to support multi-service applications with the installation of barriers and snap-in or screw type face plates.

Step 1: Select Recessed Wall Mounted Box.

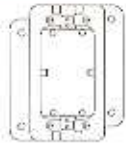

HBLWSCS1
1-Gang

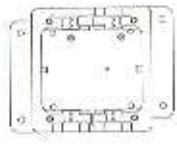

HBLWSCS2
2-Gang

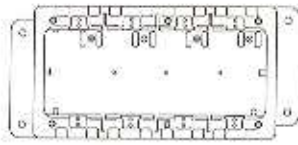

HBLWSCS4
4-Gang

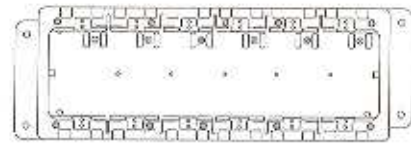

HBLWSCS6
6-Gang



HBLSCSBW
Barrier

Step 2: Select Modular Face Plate (Determine if Snap-in or Screw Type is required).

• SNAP-IN TYPE

Duplex



HBLST302(x)

Style Line®



HBLDE301(x)

Toggle



HBLTO310(x)

Blank



HBLBL300(x)

Hubbell



HBL317(x)

AMP-ACO



HBLAM303(x)

AMP



HBLAMP313(x)

Krone/Leviton



HBLKR314(x)

Lucent



HBLLT309(x)

Nordx



HBLNO309(x)

Nordx DVO1



HBLNO311(x)

Nordx DVO2



HBLNO312(x)

Ortronics



HBLOR306(x)

Panduit



HBLPA308(x)

Siemon



HBLSI305(x)

Siemon #2



HBLSI315(x)

• **COLOR OPTIONS** White (WA), Ivory (I), Gray (GY), Black (BK): (x) designates color as catalog number suffix.

• **SCREW TYPE** Add suffix "S" before specifying color.

Step 3: Select Wall Flanges.



HBLTRIM1W(x)
1-Gang



HBLTRIM2W(x)
2-Gang

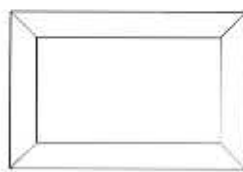

HBLTRIM4W(x)
4-Gang



HBLTRIM6W(x)
6-Gang



SIDE VIEW

• **COLOR OPTIONS** White (WA), Ivory (I), Gray (GY), Black (BK): (x) designates color as catalog number suffix.

• DIMENSIONAL DATA

Dimensions in Inches (mm)						
CATALOG #	HEIGHT	WIDTH	DEPTH	GANGS	KNOCKOUTS	
HBLWSCS1	4.44 (112.8)	2.56 (65.0)	2.75 (69.8)	1	1/2", 3/4"	
HBLWSCS2	4.44 (112.8)	4.56 (115.8)	2.75 (69.8)	2	1/2", 3/4"	
HBLWSCS4	4.44 (112.8)	8.56 (217.4)	2.75 (69.8)	4	1/2", 3/4", 1"	
HBLWSCS6	4.44 (112.8)	12.56 (319.0)	2.75 (69.8)	6	1/2", 3/4", 1"	
HBLTRIM1W	6.75 (171.4)	4.25 (107.9)	.25 (6.3)	1		
HBLTRIM2W	6.75 (171.4)	6.25 (158.7)	.25 (6.3)	2		
HBLTRIM4W	6.75 (171.4)	10.25 (260.3)	.25 (6.3)	4		
HBLTRIM6W	6.75 (171.4)	13.25 (336.5)	.25 (6.3)	6		

UL File # E31999
CSA File # LR702145

Recessed Wall Boxes

Multi-Connect

Division 16 Specifications

Part 2: Products

2.01 Manufacturer

A. The recessed wall boxes, modular face plates, wall flanges and barriers specified herein for branch circuit wiring shall be the Hubbell Multi-Connect System as manufactured by Hubbell Inc. Wiring Device-Kellems® or approved equal. Other manufacturers may be considered equal if they meet the performance requirements of this specification and have received prior written approval.

2.02 Components/Accessories

A. The barriers required to separate power from low voltage chambers shall be Hubbell type **HBLSCSBW**.

2.03 Materials

A. RECESSED WALL MOUNTED BOXES

Recessed wall mounted boxes shall be manufactured to accommodate one, two, four and six-gang applications. Barriers are to be furnished separately to isolate power from low voltage circuits (**HBLSCSBW**). A separate ground terminal will be provided for each gang. Recessed wall boxes shall be made of galvanized 16 gauge cold rolled steel construction to adapt for installations in wood or metal-framed walls. Box will be furnished with two adjustable stud mounting brackets to support a 1/2", 3/4", 1" or 1 1/4" wallboard. Boxes will also include an adjustable PVC device mounting platform to assure a flush appearance. Combination knockouts will support 1/2", 3/4" and 1" conduit feeds.

Hubbell Type	Gang	Knockouts
HBLWSCS1	1	1/2", 3/4"
HBLWSCS2	2	1/2", 3/4"
HBLWSCS4	4	1/2", 3/4", 1"
HBLWSCS6	6	1/2", 3/4", 1"

B. MODULAR FACE PLATES

Face plates shall be made of high strength PVC (UL94V-0 rated) and furnished with a textured pebble finish. Means of fastening include snap-in or screw type installations. Duplex, Style Line®, toggle and various data openings are provided to support flush data requirements. A blank face plate is also available to support future applications. Colors available include white, ivory, gray and black.

Power & Future Use	Low Voltage - (Manufacturer Opening)	
HBLDE301 - (Style Line)	HBLAM303 - (Amp-ACO)	HBLNO311 - (Nordx DVO1)
HBLST302 - (Duplex)	HBLAMP313 - (Amp)	HBLNO312 - (Nordx DVO2)
HBLTO310 - (Toggle)	HBLKR314 - (Krone, Leviton)	HBLOR306 - (Ortronics)
HBLBL300 - (Blank)	HBL317 - (Hubbell)	HBLPA308 - (Panduit)
	HBLLT309 - (Lucent)	HBLSI305 - (Siemon)
	HBLNO309 - (Nordx)	HBLSI315 - (Siemon #2)

C. WALL FLANGES

Wall flanges shall be mounted to recessed boxes listed above and be made of high strength PVC. All flanges will be furnished with a textured pebble finish. Hubbell type **HBLTRIM1W** (1-Gang), **HBLTRIM2W** (2-Gang), **HBLTRIM4W** (4-Gang) and **HBLTRIM6W** (6-Gang) are available to support the box of matching gangs. Colors available include white, ivory, gray and black.



® Wiring Device - Kellems

Hubbell Incorporated (Delaware) • 185 Plains Road • Millerd, CT 06460-2420 • (203) 882-4800 • FAX (800) 255-1031 • in CT (203) 882-4849
World Wide Web URL: <http://www.hubbell-wiring.com>

Worldwide Locations

Hubbell Canada (905) 839-1138, Fax (905) 839-9108
Hubbell Ltd. England (441) 234-855444, Fax (441) 234-854008
Hubbell-Taian Co., Ltd., (886) 2 567-5995, Fax (886) 2 567-4853

Hubbell de Mexico, S.A. de C.V. (52) 5 575-2022, Fax (52) 5 559-8626
Caribe Sales Agencies, Puerto Rico (809) 720-7185, Fax (809) 789-2796