

VERTICAL POWER STRIPS

For CPI Cabinet Systems

KEY FEATURES

- Distribute power to multiple devices from a single power connection.
- NEMA or IEC style connectors.
- Cabinet-mount brackets included. Uses no rack-mount spaces (RMU).
- Optional circuit breaker protects circuit from overload.
- Optional surge-protection protects equipment from power spikes.
- Optional current meter measures current load on power strip.

APPLICATIONS

- Use Vertical Power Strips on CPI Cabinets that support rack-mount computer and data storage equipment.
- Vertical Power Strips distribute single-phase power to multiple pieces of equipment from a single power connection.

USE WITH

- M-Series MegaFrame® Cabinet System
- C-Series SlimFrame™ Cabinet System
- T-Series SteelFrame Cabinet System
- Seismic Frame® Cabinet System

RELATED ACCESSORIES

- High-Voltage PDUs
- MINUTEMAN® UPS
- 19" Rack-Mount Power Strips
- Vertical Power Strips for CPI Racks
- Dual-Input Power Strips
- Triple-Input Power Strips
- Three-Phase Power Strips

Sold by:

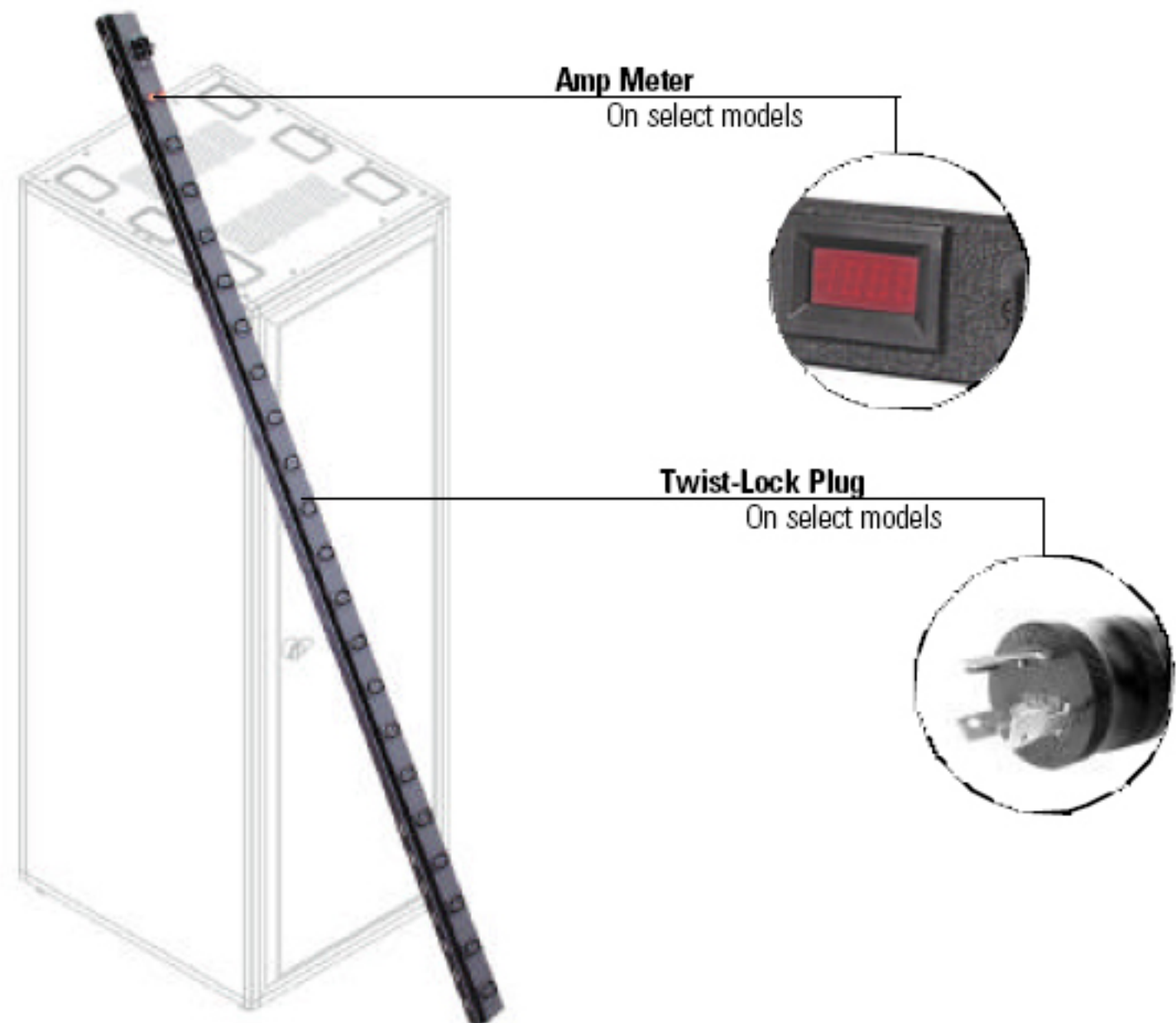

CPI Cabinet Systems support rack-mount computer and data storage equipment. Vertical Power Strips allow multiple pieces of equipment to share a single power connection.

Vertical Power Strips attach to the side of the cabinets saving rack-mount spaces for equipment. Vertical Power Strips can be adjusted front-to-rear to align with equipment, and several power strips can be installed in each CPI Cabinet to supply multiple circuits in support of redundant power.

Power strips equipped with optional circuit breakers and surge-protection provide additional power protection. Circuit breakers limit the amount of current available to the equipment. Surge protection blocks excessive voltage from equipment. Both features are critical with unconditioned line power.

Select models also have a built in current meter with a digital display that shows the amount of current on the power strip. This feature assists with power management by allowing the user to judge the remaining capacity on the power strip before adding a new device to the circuit.

Choose Power Strips to match the voltage and current rating of the power connection. NEMA-NEMA, NEMA-IEC or IEC-IEC style plug and outlet combinations are available. IEC style connectors allow power cords to be custom matched to the power connection. Vertical, 19" rack-mount, multi-input and multi-phase power strips are also available.

See inside for product selection. Contact CPI Technical Support (800-834-4969) for configuration assistance.