

REVISION					
REV	DESCRIPTION	ECO NO.	DATE	BY	CHK'D BY ENGR APP'D
A	PRODUCTION RELEASE.		06/15/01	JB	ME
B	REDRAW SCHEM. ADD TABLE.		01/22/02	JB	ME
C	ITEM 2 PN WAS 18674-02.		02/24/03	JB	ME
D	CONNECTOR WAS 6-PIN.		01/18/05	JB	BC

FEATURES

PUSH-TO-TALK SWITCH

MOMENTARY OR LOCKING, SELECTABLE.

CABLES CAPSULE

12 INCHES, WITH AN ULTRA QUICK-DISCONNECT.

CONNECTOR CONNECTOR

SEE TABLE. STEWART COMPU-SHIELD PN SS-311010-26.

COLOR WARRANTY

BLACK. 2 YEARS.

MODEL	CABLE LENGTH (EXTENDED)
SHS 2201-10	10 FT COIL
SHS 2201-15	15 FT COIL
SHS 2201-25	25 FT COIL

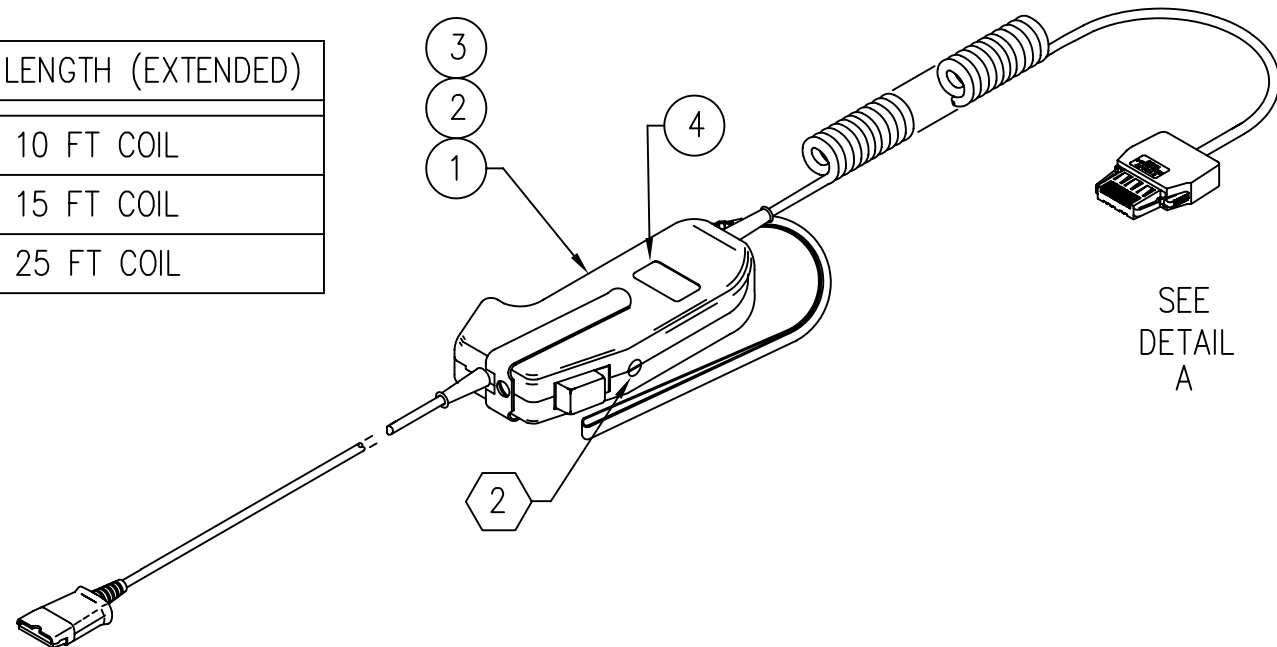

SEE DETAIL A

3. THIS IS A PTT SWITCHCASE WITH A STEWART COMPU-SHIELD CONNECTOR, FOR USE WITH PLANTRONICS ULTRA-TYPE TOPS.

② SET THE SELECTOR TO THE LOCKING POSITION.

1. IMPRINT THE MODEL NUMBER AND DATE CODE ON THE AMPLIFIER HOUSING PER DWG 13629.

NOTES: (UNLESS OTHERWISE SPECIFIED)

REF 24870, 26093

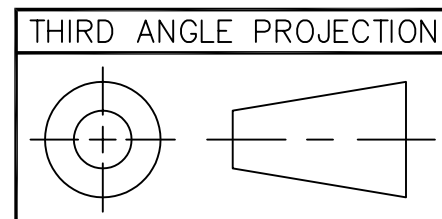

SEE SEPARATE BILL OF MATERIALS

MATING PART. SEE NOTE

PLANTRONICS RESTRICTED

This document contains Plantronics, Inc. proprietary data, and is not to be copied, reproduced, used or divulged to unauthorized persons, in whole or in part, without proper authorization in writing from Plantronics, Inc. which reserves all rights to it.

UNLESS OTHERWISE SPECIFIED DIMENSIONS ARE IN: INCHES AND TOLERANCES ARE: DECIMAL .XX = ± .01 .XXX = ± .005 ANGLE = ± 2' FRACTION = ± 1/16 MATERIAL: FINISH:	DO NOT SCALE		PLANTRONICS Santa Cruz, Ca. TITLE MODEL SHS 2201-10,15,25
	DRAWN BY J. BAKER 06/15/01 CHECKED BY M. ERBE 06/15/01 DEV ENG APPD JAN SHADLE 06/19/01 MFG APPD PROD ENG APPD	SIZE B CAT CODE 01 DWG NO. 92201-XX REV. D	

Special Products Packed-Level Bill of Materials

Model Number: SHS 2201-10,15,25

Part Number: 92201-XX

Revision: D

Date: 01/18/05

Receiver Configuration: NA

Connector: Stewart, Compu-Shield SS-311010-26

Capsule Type: NA

Configuration: Switchcase

[View Drawing](#) (only available when viewing BOM online in Word format)

ITEM	QTY -10	QTY -15	QTY -25	PLANTRONICS PART NUMBER	DESCRIPTION
1.	1	---	---	101062-10	HEADSET ASSEMBLY
2.	---	1	---	101062-15	HEADSET ASSEMBLY
3.	---	---	1	101062-25	HEADSET ASSEMBLY
4.	1	1	1	25478-01	LABEL
5.	1	1	1	26086-01	BOX, TWIN PACK
6.	1	1	1	41593-01	USER'S GUIDE, PLUG PRONG ADAPTER
7.	1	1	1	25686-02	SLEEVE, FOAM

92201-D.doc

