

Porcelain Adapter

(Mogul-to-Medium)

One-piece, white glazed porcelain body. Aluminum screw shell.

Standard pack: bulk

Cat. No. 8681

- 660W-250V
- UL Listed E-13396
- CSA Certified LR-1863



SECTION D

Phenolic Flanged Adapter

Phenolic body with standard male screw shell reinforced and eyeleted in place. Leads are No. 18 ga. 105°C AWM-TEW plastic insulated wire, 4 1/2" long, stripped 1/2" unless otherwise specified. Aluminum screw shell.

Standard pack: bulk

Cat. No. 165

Cat. No. 165-001 Same as No. 165, less leads

- 660W-250V
- UL Recognized Component **RU** E-13396

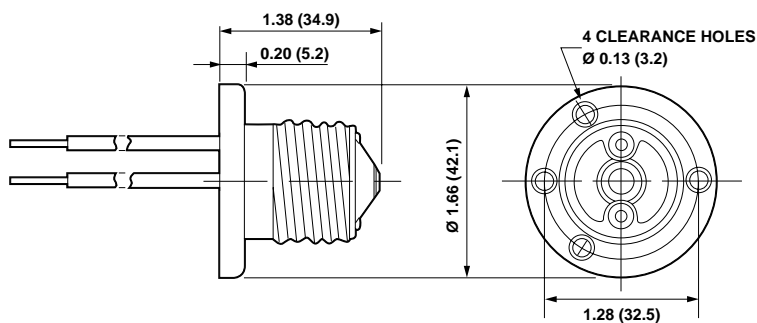

Cat. No.165

