

Single Pole Cam-Type Connectors

22/23 Series — Latching Ball Nose/Latching Taper Nose — Up to 690 AMP,* 600V

*Refer to Ampacity Chart for all cable sizes on page JJ2

Ball Nose—In-Line Latching Male Connectors—Crimped (Cable Size: 250–350MCM)

COLOR	COMPLETE CAT. NO.	CONTACT CAT. NO.	INSULATOR CAT. NO.
Black	22L21-E	22L21-C	22SVM-E
White	22L21-W	22L21-C	22SVM-W
Red	22L21-R	22L21-C	22SVM-R

Ball Nose—In-Line Latching Female Connectors—Crimped (Cable Size: 250–350MCM)

COLOR	COMPLETE CAT. NO.	CONTACT CAT. NO.	INSULATOR CAT. NO.
Black	22L24-E	22L24-C	22SVF-E
White	22L24-W	22L24-C	22SVF-W
Red	22L24-R	22L24-C	22SVF-R

Ball Nose—In-Line Latching Male Connectors—Crimped (Cable Size: 350–500MCM)

COLOR	COMPLETE CAT. NO.	CONTACT CAT. NO.	INSULATOR CAT. NO.
Black	22L22-E	22L22-C	22SVM-E
White	22L22-W	22L22-C	22SVM-W
Red	22L22-R	22L22-C	22SVM-R

Ball Nose—In-Line Latching Female Connectors—Crimped (Cable Size: 350–500MCM)

COLOR	COMPLETE CAT. NO.	CONTACT CAT. NO.	INSULATOR CAT. NO.
Black	22L25-E	22L25-C	22SVF-E
White	22L25-W	22L25-C	22SVF-W
Red	22L25-R	22L25-C	22SVF-R

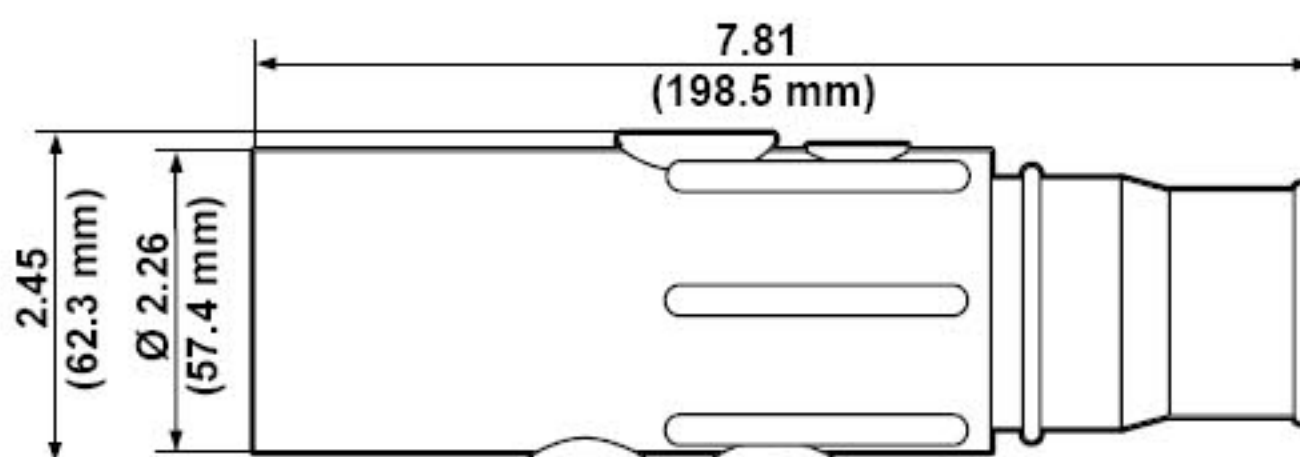

BALL NOSE IN-LINE LATCHING MALE CONNECTORS—CRIMPED
Cat. No. 22L21

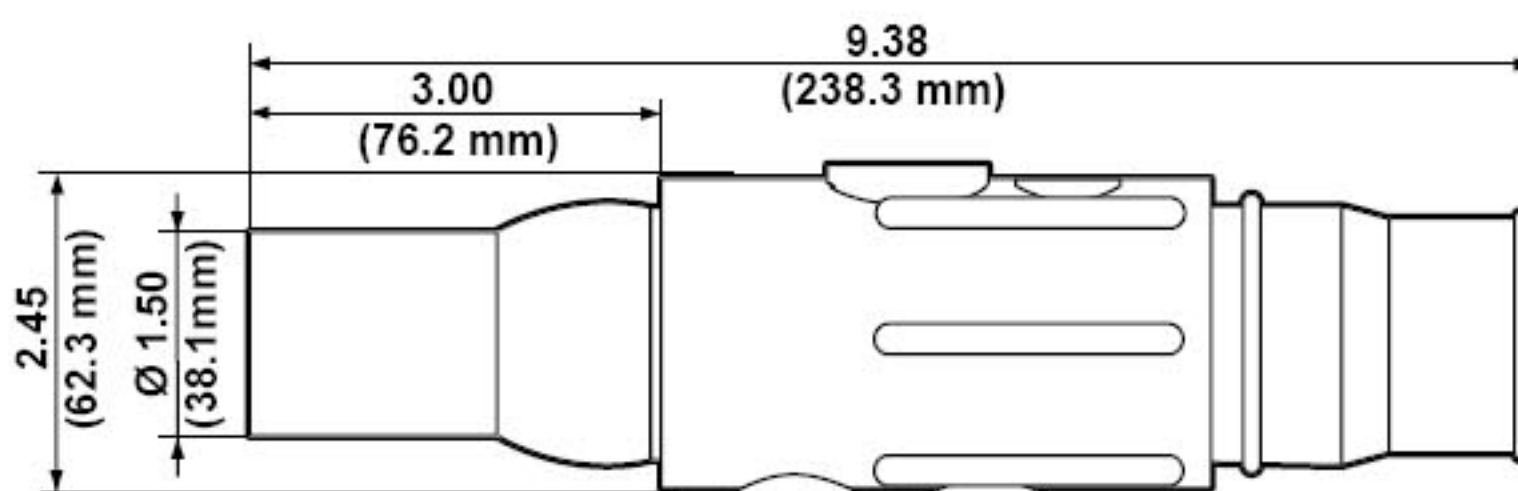

BALL NOSE IN-LINE LATCHING FEMALE CONNECTORS—CRIMPED
Cat. No. 22L24

SPECIFICATIONS & FEATURES

- Leviton's Cam-Type positive latching connectors and receptacles are the standard used by Navy bases and shipyards in supplying 480 volts AC 3-phase power to ships at dockside. Our latching connector series has been thoroughly and successfully tested by ETL Laboratories to meet Navy specifications, including interchangeability with competition. Our latching connector series provides heavy duty, completely insulated connectors that are vibration-resistant and positively lock into place. Leviton latching connectors will not vibrate, twist or turn loose, ensuring high conductivity and maximum efficiency. Leviton contacts can be retrofitted to existing locations and power distribution systems. Our male contacts are designed to provide 40% more surface contact with the female vs. competitive products. The additional efficiency will help ensure greater conductivity while preventing burnout.
- The connectors and all components are completely interchangeable with competitive cam-type products.

TESTING & CODE COMPLIANCE

- ETL Tested, Report #521300
- Waterproof (when vulcanized) and fire-resistant for outside usage