



17 Series — Taper Nose — Up to 690 AMP,* 600V

*Refer to Ampacity Chart for all cable sizes on page JJ2

Male Detachable Plug—Double Set Screw (Cable Size: 350–500MCM)

COLOR	COMPLETE CAT. NO.	CONTACT CAT. NO.	INSULATOR CAT. NO.
Black	17D22-E	17D22-C	17SDM-E
White	17D22-W	17D22-C	17SDM-W
Red	17D22-R	17D22-C	17SDM-R
Blue	17D22-B	17D22-C	17SDM-B
Green	17D22-G	17D22-C	17SDM-G
Yellow	17D22-Y	17D22-C	17SDM-Y
Orange	17D22-O	17D22-C	17SDM-O
Brown	17D22-H	17D22-C	17SDM-H

Female Detachable Plug—Double Set Screw (Cable Size: 350–500MCM)

COLOR	COMPLETE CAT. NO.	CONTACT CAT. NO.	INSULATOR CAT. NO.
Black	17D24-E	17D24-C	17SDF-E
White	17D24-W	17D24-C	17SDF-W
Red	17D24-R	17D24-C	17SDF-R
Blue	17D24-B	17D24-C	17SDF-B
Green	17D24-G	17D24-C	17SDF-G
Yellow	17D24-Y	17D24-C	17SDF-Y
Orange	17D24-O	17D24-C	17SDF-O
Brown	17D24-H	17D24-C	17SDF-H

SPECIFICATIONS & FEATURES

- The 17 Series Taper Nose connectors withstand grueling, heavy-duty industrial use. Applications include generator test stations, water purification plants, electro-chemical machining equipment and other general industrial uses.

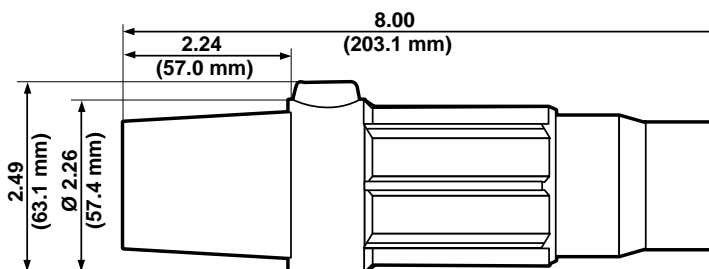

MALE DETACHABLE PLUG—DOUBLE SET SCREW
Cat. No. 17D22

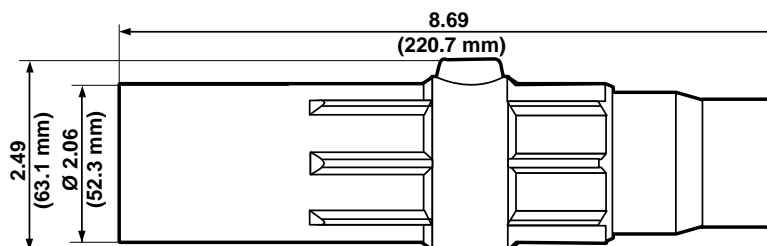

FEMALE DETACHABLE PLUG—DOUBLE SET SCREW
Cat. No. 17D24

