

Conduit-Fitting Screwdriver

- Hooded-blade design keeps tip from slipping out of screws, especially when tightening hard-to-reach screws like those in conduit fittings.



19360

Cat. No.	Shank Tip Width	Shank Length	Overall Length	Weight (lbs.)
19360	3/8" (9.5 mm)	1" (25 mm)	5- 11/32" (153 mm)	.24

⚠WARNING: NOT insulated. Plastic-dipped or slip-on plastic handles are NOT intended for protection against electrical shock.



Conduit Reamer

- Locks onto screwdrivers; reams and smooths thin-wall conduit.
- Reams ID and OD at the same time.
- Two set-screws to fit round- or square-shank screwdrivers.
- Fits up to 3/8" (10 mm) keystone-tip screwdrivers.
- NOT for use on power tools.

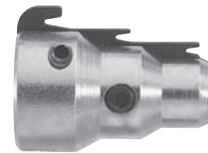

19352

Cat. No.	Conduit Capacity	Weight (lbs.)
19352	1/2", 3/4", 1"	.16
19351	replacement blade for 19352	.01

Conduit-Fitting and Reaming Screwdriver

- Hooded-blade design keeps tip from slipping out of screws, especially when tightening hard-to-reach conduit fittings. Thicker hood is designed for rugged use.
- Reams and smooths 1/2" (13 mm), 3/4" (19 mm), and 1" (25 mm) thin-wall conduit ends to protect wire and permit correct installation of fittings.
- Reams both the inside and outside of the conduit at the same time.
- Longer Cushion-Grip handle provides comfort and more torque for reaming.
- Replaceable reaming blade is now held in place with a 1/16" hex socket set screw.



85191

Cat. No.	Shank Tip Width	Shank Length	Overall Length	Weight (lbs.)
85191	3/8" (10 mm)	2-1/2" (64 mm)	7-1/2" (191 mm)	.55
19353	conduit reamer replacement blade kit			.01

All dimensions are in inches and (millimeters).

⚠WARNING: Always wear approved eye protection.

⚠WARNING: Do NOT use with power tools.

