

THIS COPY IS PROVIDED ON A RESTRICTED BASIS AND IS NOT TO BE USED IN ANY WAY DETRIMENTAL TO THE INTERESTS OF PANDUIT CORP.

PANDUIT P/N	WEIGHT
FMP6	.243 LB/10 PCS. (.110 G/10 PCS.)

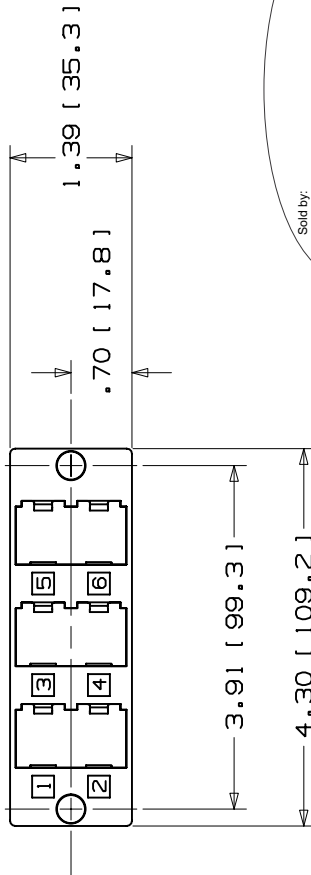

- NOTES:  
 SEE CURRENT CATALOG FOR ADDITIONAL PART SUFFIXES TO INDICATE COLOR AND OR PACKAGE QUANTITY.  
 PANEL ACCEPTS UP TO SIX MINI-COM CONNECTOR MODULES FOR FIBER OPTIC, UTP, SCTP AND COAX APPLICATIONS.  
 3. DIMENSIONS IN PARENTHESIS ARE IN METRIC.

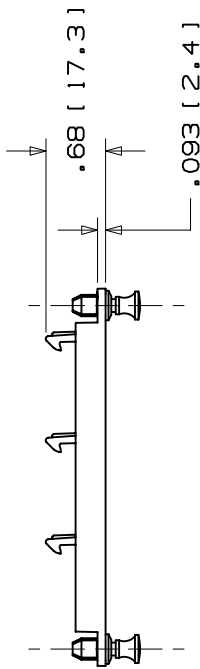
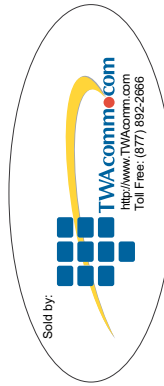
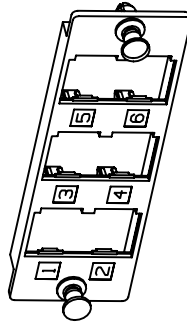

CAD FILENAME/LAYERS D35560BL\_DC\_6\_PACK\_00.PRT (5)

**PANDUIT**  
 CORP. TINLEY PARK, ILLINOIS  
 MULTI-MEDIA SIX PORT PANEL  
 BLANK (FMP6)  
 CUSTOMER DRAWING

UNLESS OTHERWISE SPECIFIED, DIMENSIONAL TOLERANCES ARE: (.X) ± .XXX) ± .010 (.3) (.XX) ± .031 (.8) ANGLES ±		UNLESS OTHERWISE SPECIFIED, ALL DIMENSIONS ARE GIVEN IN INCHES, THIRD ANGLE PROJECTION.	
DRAWN BY TPC	MAT'L: ABS	SCALE HALF	DWG NO. 35560-12
DATE 10-14-96	CHK'D		SIZE A
REV	DATE	BY	CHK
R	10-14-96	TPC	
			RELEASED TO PRODUCTION
			DESCRIPTION
			ECN - R CUST SUP