

# RACK MOUNT INTERCONNECT CENTER (RIC)

The new, improved RIC3 provides the best overall value for fiber management available. The RIC3 enclosure offers superior fiber density (up to 288 fibers in just 4 RMS) without sacrificing fiber protection and accessibility. New features include a fully removable tray, improved labeling, standard front and rear door locks, and single-finger door latch. With better cable management, port identification, fiber accessibility and security, the RIC3 is the best way to protect valuable fiber connections.

Management tray has a positive stop in both front and rear working positions providing complete access to patch cords/connectors for moving adding, changing, or cleaning of fibers



**PATENTED  
ENHANCED**



The RIC3 enables a maximum amount of fibers to be patched or patched and spliced in a 2, 3, and 4 RMS enclosure without compromising the accessibility of fibers/connectors/splices resulting in more efficient utilization of rack space

Rotating grommets facilitate loading and retention of jumpers and fiber while minimizing microbending stress when using the sliding tray

Dual-level cable managers provide independent levels for routing fibers

Spring loaded quick-release hinges enable easy removal of front and rear doors for complete access to fiber connections

Label virtually any port configuration with our improved labels, which hang on the front door for improved visibility. When the door is opened, labels flip down letting the label and corresponding ports be viewed together.

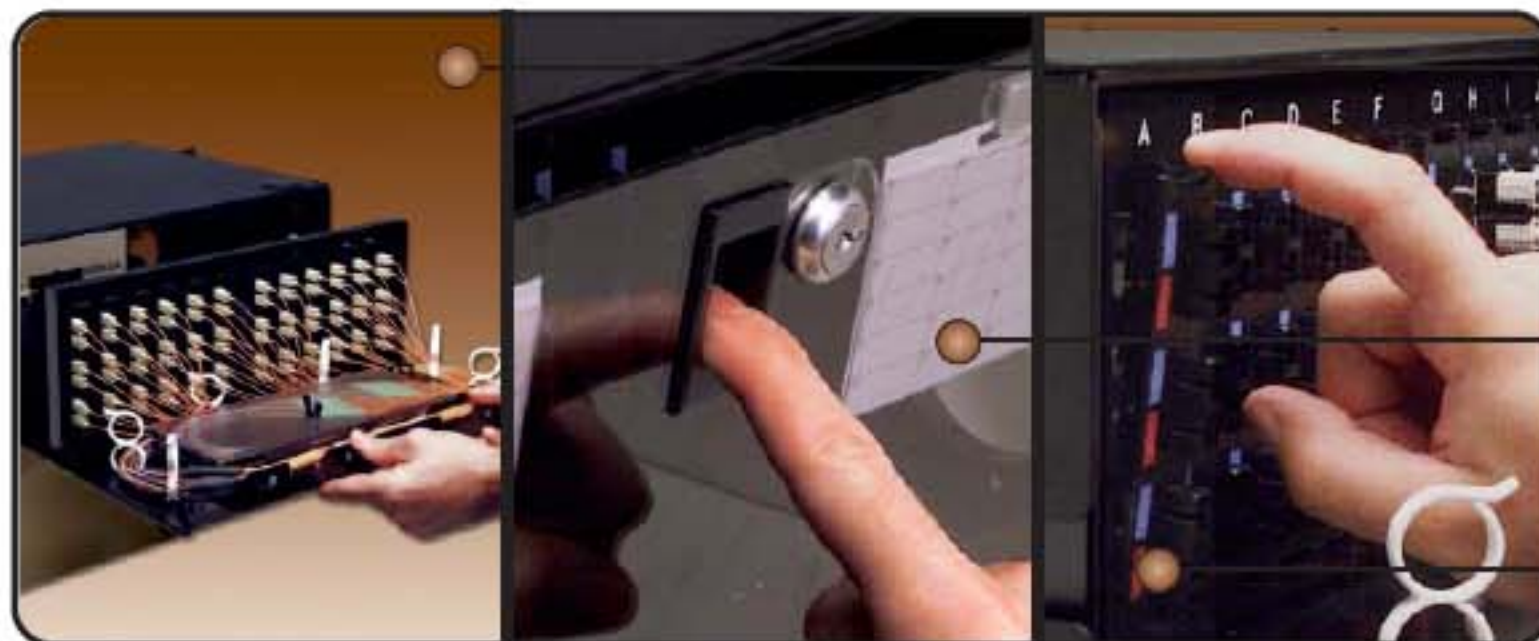

*The RIC3 cable management tray is now completely removable from the front or rear of the enclosure, allowing the entire tray to be moved to a work table for more convenient loading of adapter plates, pigtails and splice trays*

*The new RIC3 features a single-finger latch on both front and rear doors. Included door locks prevent unauthorized access for enhanced security*

*Never fumble with clumsy nylatches in a densely packed fiber enclosure again! Siemon Quick-Pack™ Adapter Plates can be inserted or removed with a single-finger for quick and easy access to fiber even in fully loaded enclosure*